

GEARED TRACTION MACHINE

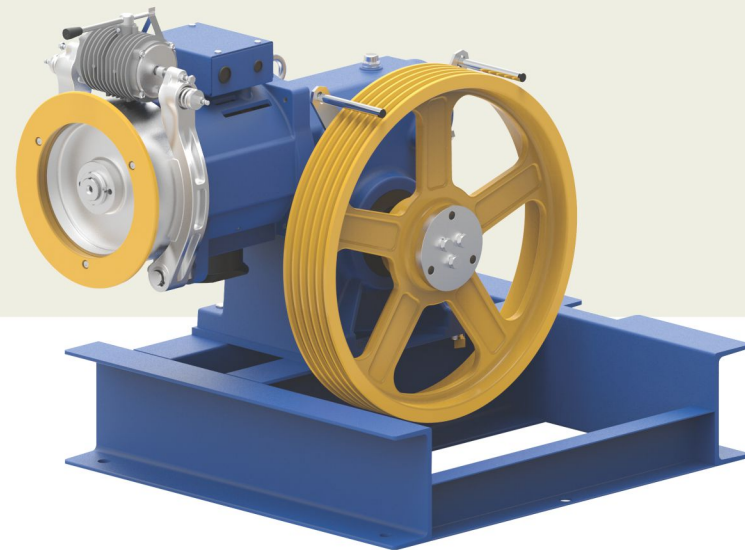

GEARED TRACTION MACHINE



Listed loads don't include the rope's weight.
In order to know the net loads capacity, subtract rope's weight from the listed loads.

Position of the gearbox Up
Counter weight 50%
Plant efficiency 0.80

Machine	Duty Load		Roping	Async. Speed (m/sec)	Ratio	Motor Detail		RPM (Async.)	Rated Current (A)	Sheave Specification Sheave Dia x Rope Dia. X No. of Groove
	Person	Kg				kw	(HP)			
ZORRO	16	1088	1:1	1.00	1/46	11.0	15.0	1445	24.5	Ø 600 X 13mm X 4 Grv.
		2000	2:1	0.50	1/46	11.0	15.0	1445	24.5	Ø 600 X 13mm X 4 Grv.

AC VVVF

400 V

50 Hz

Travelling : - 30 mtr

Kindly contact us for various speed and load combination

Static Load (kg)
4200

Gear Ratio
1/46

Brake Voltage (DC)
110V, 220V

Oil Capacity (Ltr)
5.0

Weight of Machine (kg)
381* (With Bed Plate)*

* Weight of machine is varies according to selection of sheave, motor.

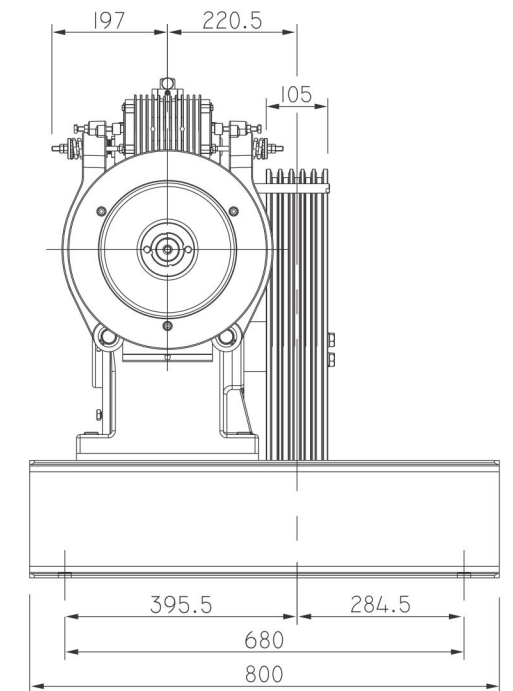
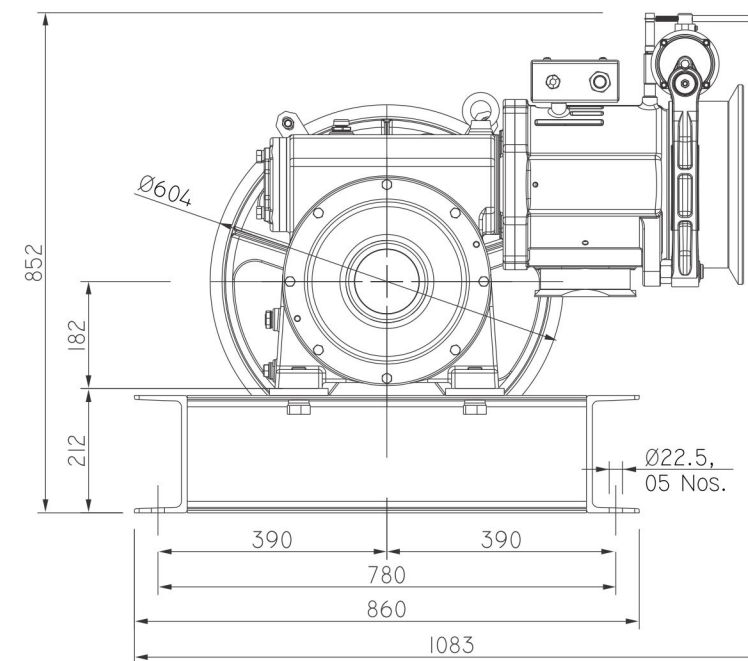
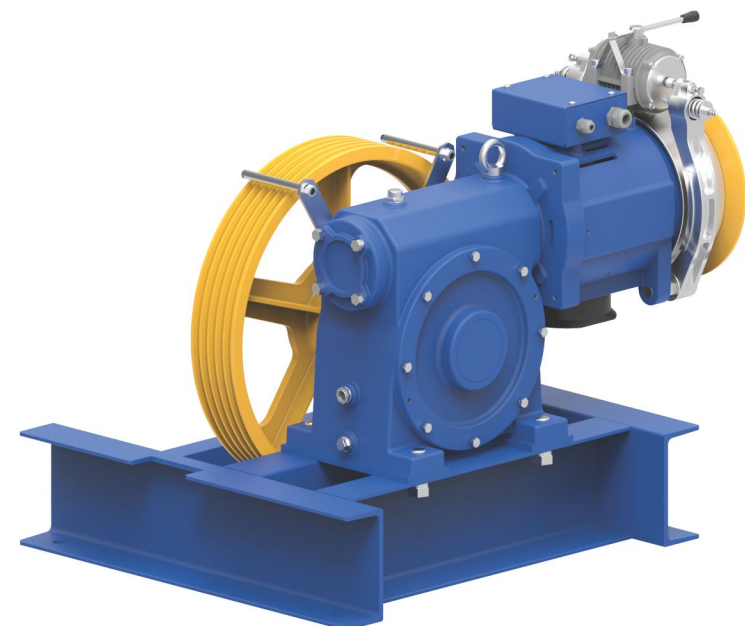

(All dimensions are in mm)