

SINCE : 1995

More Powerful More  
*Efficient*

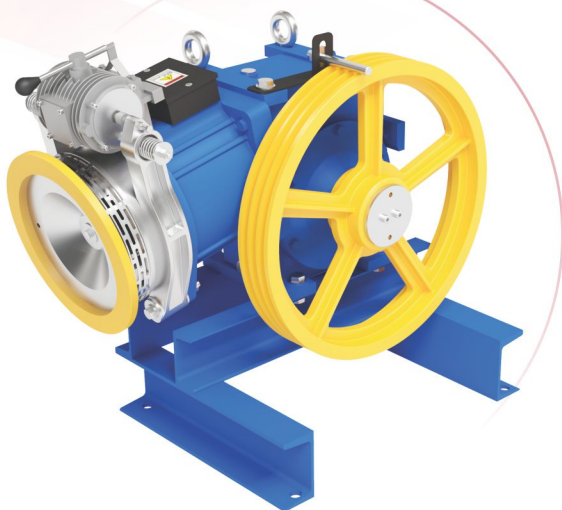

GEARLESS & GEARED TRACTION MACHINE 

 | **VARSHA**<sup>TM</sup>  
ENGINEERS



A VISION  
FOR THE FUTURE

Dinesh Panchal  
Founder

Bhavesh Panchal  
Director



### Our Relationship

Varsha Engineers was envisaged, promoted and incorporated by Mr. Dineshbhai Panchal in Ahmedabad in the year 1995. The company was well planned and established to manufacture prime quality Elevator Traction Machine.



### Our Target

Driven by the passion to create world-class entity for itself, the company has an environment that encourages the best potential management which incorporates the best technology.



### Our Vision

An entrepreneurship which is a committed organization with a sincere endeavour, with a foresight of vision and earnest passion to rise and serve, excel and grow, perform and prove.

## COMPANY OVERVIEW

A dream project that was an envision of Mr. Dinesh Panchal was incorporate after all 'pros & cons' were worked out for a meticulously engineered planning with global innovative business initiative & acumen aided by experienced & qualified professionals.

Varsha Engineers was established in the year 1995 in Ahmedabad, the industrial capital city of Gujarat to manufacture precision prime quality 'Elevator Traction Machine'. The company work facility has an adequate vast expand to accommodate all in-house work force. Mr. Dineshbhai maintains 'self observation' which is the first step of the inner folding of the Business Rule-Book. The company ensures good management practices with a vibrant and performance driven environment with excellent opportunities for product enhancement and all round growth. The manufacturing operation is a multi-disciplinary engineering concept fully integrated in terms of expertise, know-how and ultra techniques.

We remain ever alert to capitalize global innovations & implement the same immediately before they become apparent. We withstand healthy global competition and develop & provide the state-of-the-art products & services in a very prompt time schedule.

We are equipped with the latest modern hi-tech infrastructure to facilitate optimum production out-put & guarantee the finest precise quality aptly backed by value based performance, ethics and spirit of excellence.

We also remain conscientious to extend client services and delivering product technical back-up by our after-sales services engineers.

Since : 1995



Kathwada Unit

[www.varshaindustries.com](http://www.varshaindustries.com)

### Export Countries



South Africa



South America



Algeria



Lebonen



Egypt



Soudi Arabia



Iraq



Sri Lanka



Bangladesh



Vietnam



Strength  
**12,000+**  
Annual  
Production  
Unit Capacity

### We have invested the best in infrastructure!

Creating the next generation products with high-end applications & induction of ultra modern techniques.





In house manufacturing :  
**Geared & Gearless**  
Traction Machine

A well equipped and planned manufacturing infrastructure possessing modern machinery for superior quality products and hassle free production.



The company has substantially invested in enhancing manufacturing capacity and capabilities to fulfil large scale orders. It is a part of the strategic infrastructure development plan which is aligned with Varsha Industries commitment of on-time delivery.



## Geared elevators with today's innovations

Geared elevators have been considered a reliable workhorse for decades. But today's geared technology provides innovations that improve elevator efficiency while reducing energy costs.

Modernizing your elevators with upgraded geared equipment including the latest digital controls, advanced dispatching and an efficient AC-drive system can be done with minimal building disruption. Along with making your elevators more reliable, this technology will lower your energy costs and helps increase your property value.





GEARED  
**VI 5 UT SMART**

Max Static Load	3000 Kg.
Power Range	3, 3.7, 4.5 kW.
Brake Voltage	48, 60, 110, 220 DC.
Sheave Range	530 mm.
Oil Capacity	3 Ltr. (Approx)
Weight	230 Kg. (Approx)

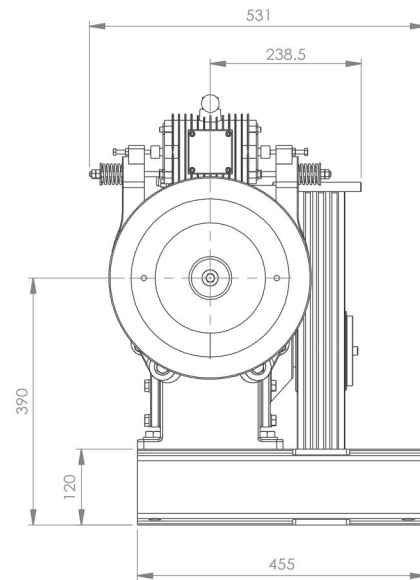
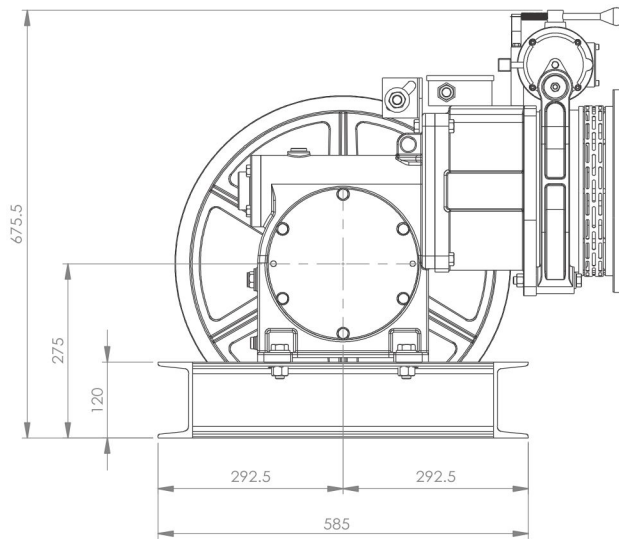
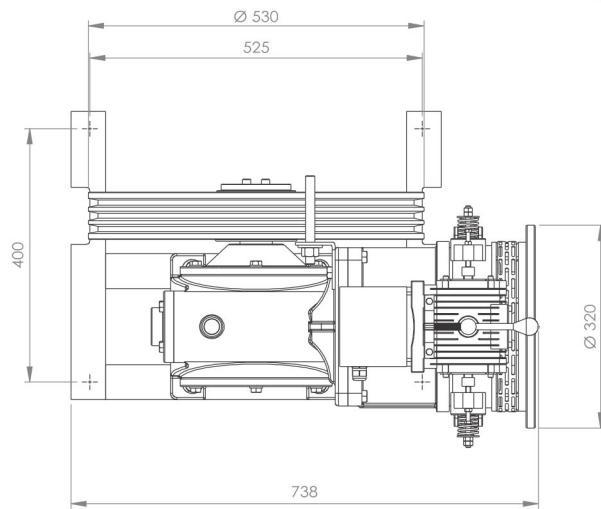
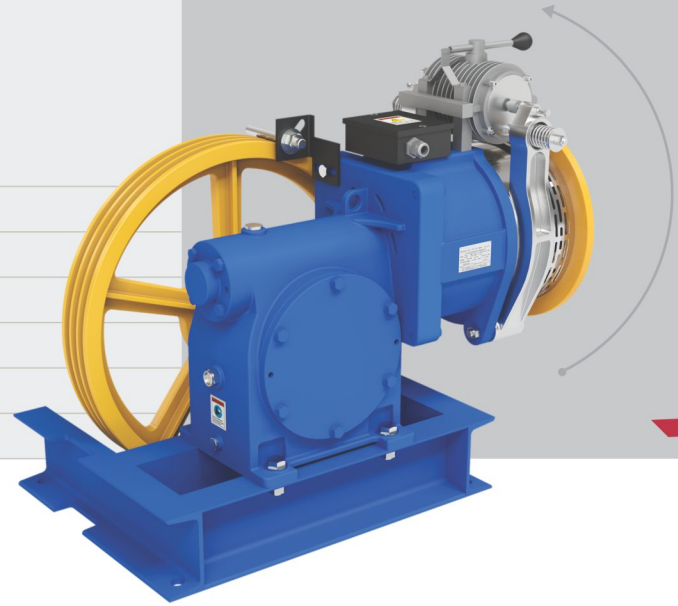

all dimensions are in mm.

Model	Load (in kg)	Speed (in m/sec)	Ratio	Sheave	Rope	Ropeing	Power (kW)	Power (HP)	Pole	Travel
VI 5 UT SMART	408	0.70	38/1	530	10/13 x 3	1:1	3.7	5	6	23
VI 5 UT SMART	544	0.35	38/1	530	10/13 x 3	2:1	3.7	5	6	21



GEARED  
VI5UT | SUPER

Max Static Load	3000 Kg.
Power Range	3, 3.7, 4.5 kW.
Brake Voltage	48, 60, 110, 220 DC.
Sheave Range	530 mm.
Oil Capacity	3 Ltr. (Approx)
Weight	240 Kg. (Approx)

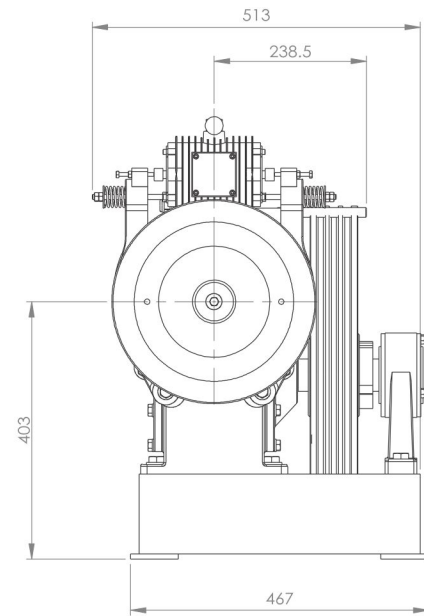
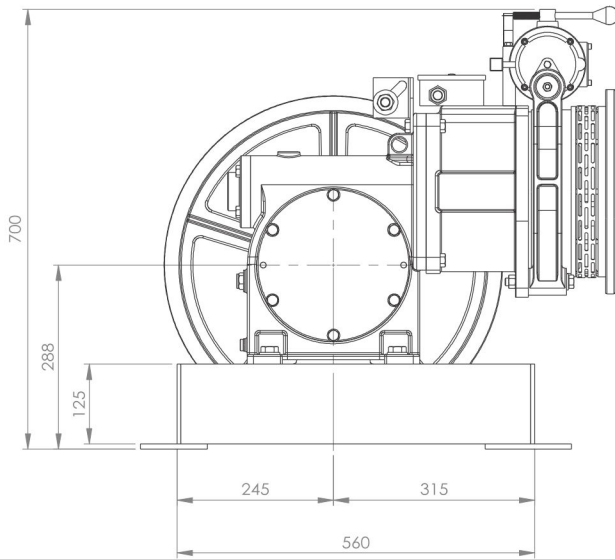
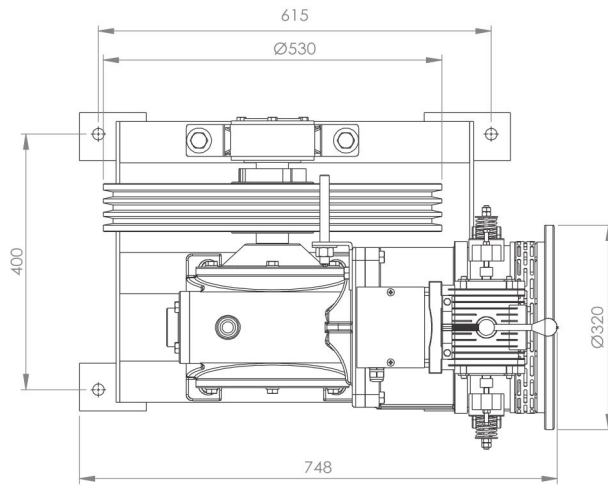
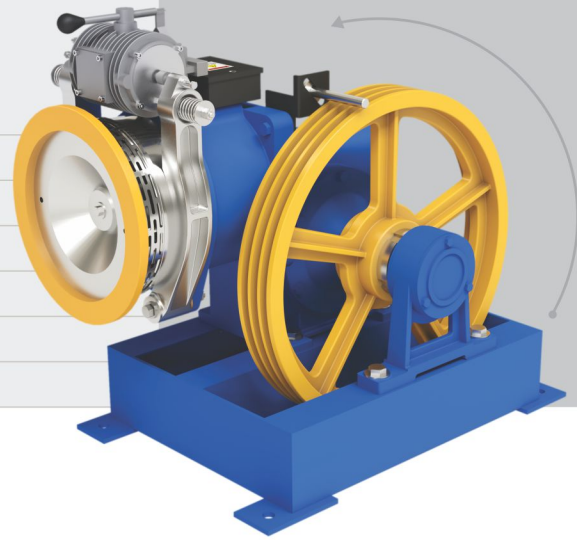

all dimensions are in mm.

Model	Load (in kg)	Speed (in m/sec)	Ratio	Sheave	Rope	Ropeing	Power (kW)	Power (HP)	Pole	Travel
VI 5 UT SUPER	408	0.70	38/1	530	10/13 x 3	1:1	3.7	5	6	23
VI 5 UT SUPER	544	0.35	38/1	530	10/13 x 3	2:1	3.7	5	6	21



# GEARED VI 5 UT 127 SMART

Max Static Load	3050 Kg.
Power Range	3.7, 4.5 kW.
Brake Voltage	48, 60, 110, 220 DC.
Sheave Range	530, 560 mm.
Oil Capacity	3.5 Ltr. (Approx)
Weight	255 Kg. (Approx)

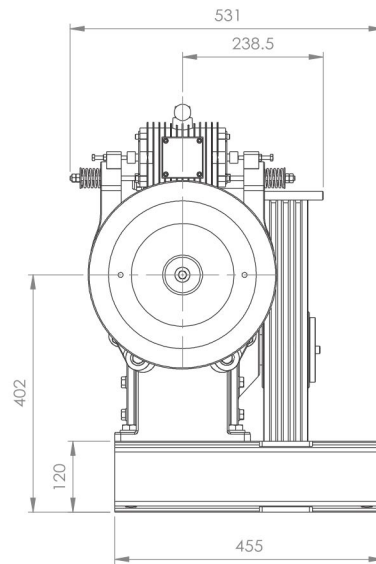
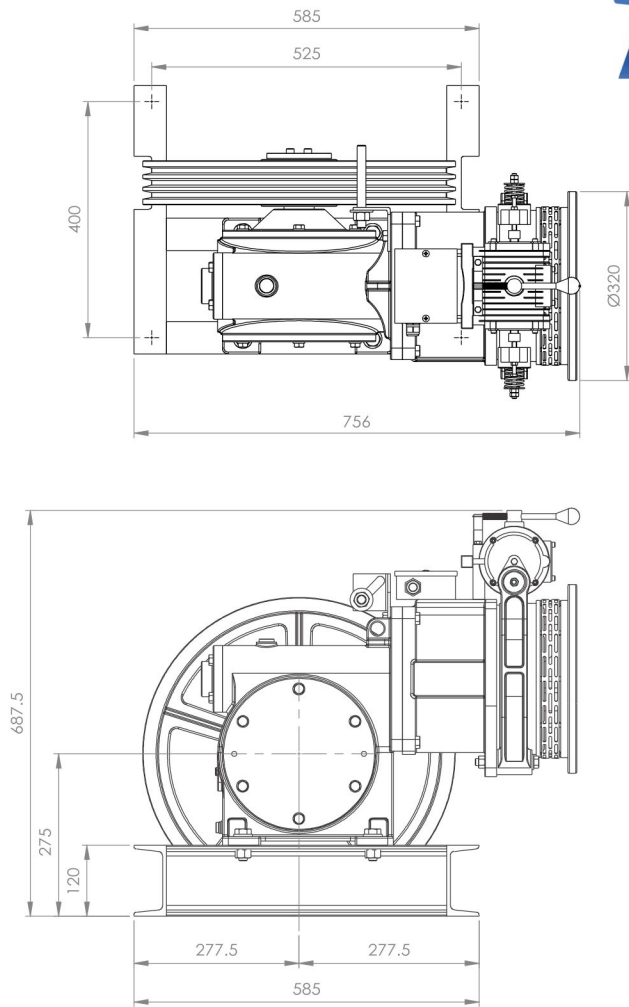
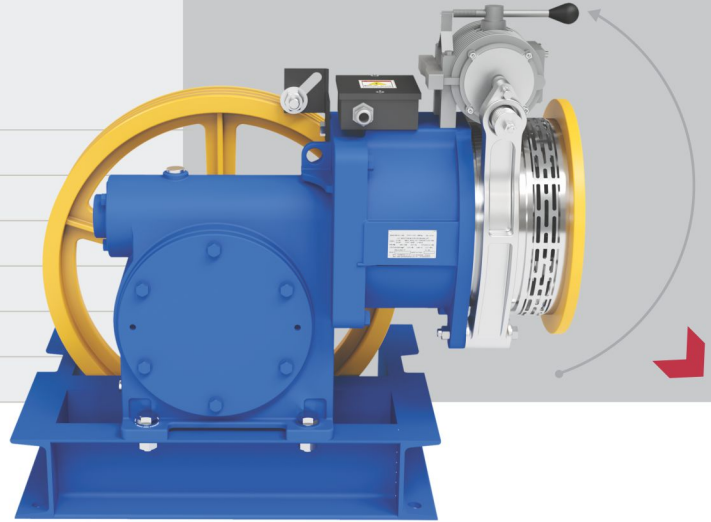

all dimensions are in mm.

Model	Load (in kg)	Speed (in m/sec)	Ratio	Sheave	Rope	Ropeing	Power (kW)	Power (HP)	Pole	Travel
VI 5 UT 127 SMART	408	0.65	40:1	530	10/13 x 3	1:1	3.7	5	6	23
VI 5 UT 127 SMART	408	0.65	40:1	530	10/13 x 3	1:1	4.5	6	6	30
VI 5 UT 127 SMART	408	1.00	40:1	530	10/13 x 3	1:1	3.7	5	4	23
VI 5 UT 127 SMART	408	1.00	40:1	530	10/13 x 3	1:1	4.5	6	4	30
VI 5 UT 127 SMART	544	0.32	40:1	530	10/13 x 3	2:1	3.7	5	6	23
VI 5 UT 127 SMART	544	0.32	40:1	530	10/13 x 3	2:1	4.5	6	6	30



# GEARED VI 5 UT 127 SUPER

Max Static Load	3050 Kg.
Power Range	3.7, 4.5 kW.
Brake Voltage	48, 60, 110, 220 DC.
Sheave Range	530, 560, 610 mm.
Oil Capacity	3.5 Ltr. (Approx)
Weight	275 Kg. (Approx)

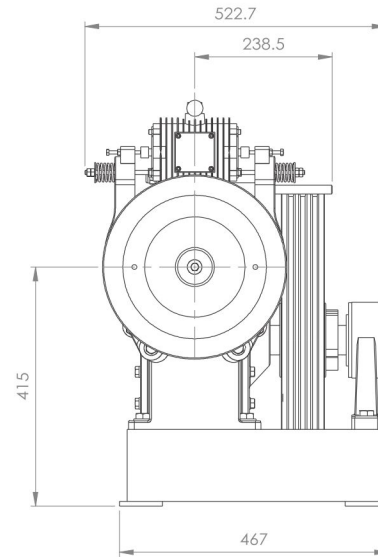
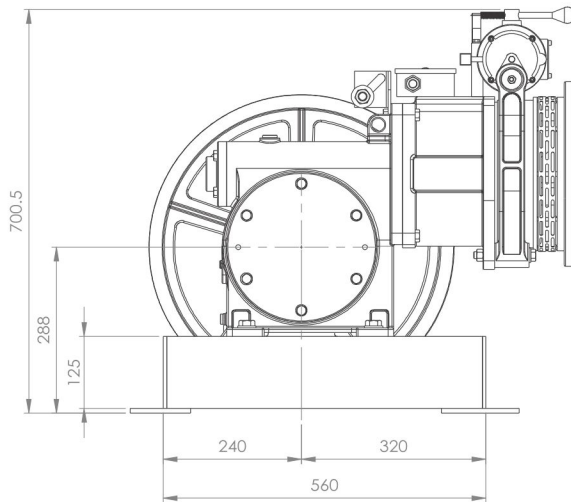
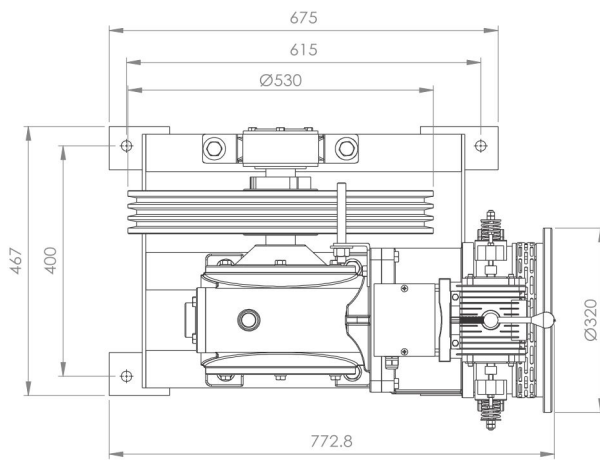
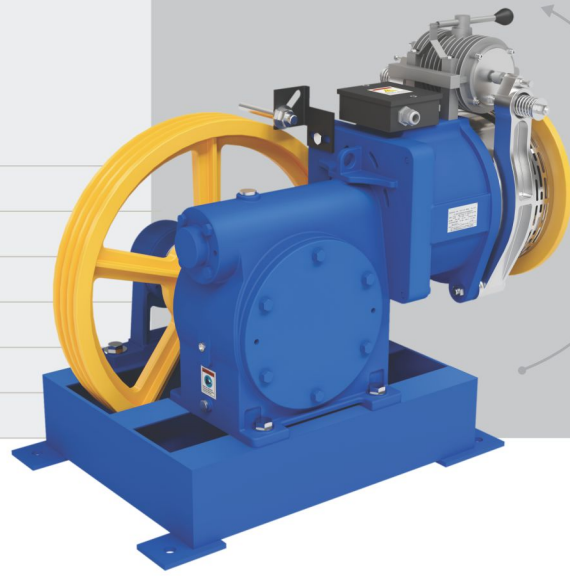

all dimensions are in mm.

Model	Load (in kg)	Speed (in m/sec)	Ratio	Sheave	Rope	Ropeing	Power (kW)	Power (HP)	Pole	Travel
VI 5 UT 127 SUPER	408	0.65	40:1	530	10/13 x 3	1:1	3.7	5	6	23
VI 5 UT 127 SUPER	408	0.65	40:1	530	10/13 x 3	1:1	4.5	6	6	30
VI 5 UT 127 SUPER	408	1.00	40:1	530	10/13 x 3	1:1	3.7	5	4	23
VI 5 UT 127 SUPER	408	1.00	40:1	530	10/13 x 3	1:1	4.5	6	4	30
VI 5 UT 127 SUPER	544	0.32	40:1	530	10/13 x 3	2:1	3.7	5	6	23
VI 5 UT 127 SUPER	544	0.32	40:1	530	10/13 x 3	2:1	4.5	6	6	30



GEARED  
**VI 7.5 UT SMART**

Max Static Load	3100 Kg.
Power Range	5.5. kW.
Brake Voltage	48, 60, 110, 220 DC.
Sheave Range	530, 560, 610 mm.
Oil Capacity	3.5 Ltr. (Approx)
Weight	265 Kg. (Approx)

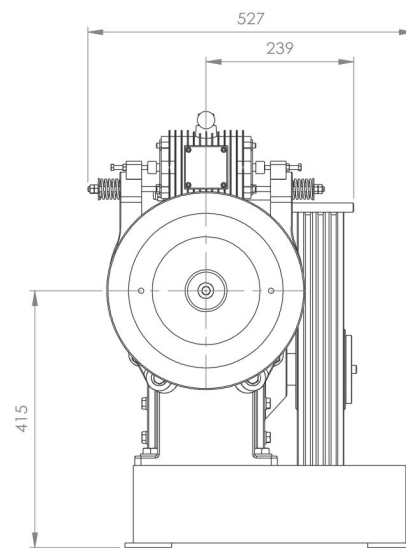
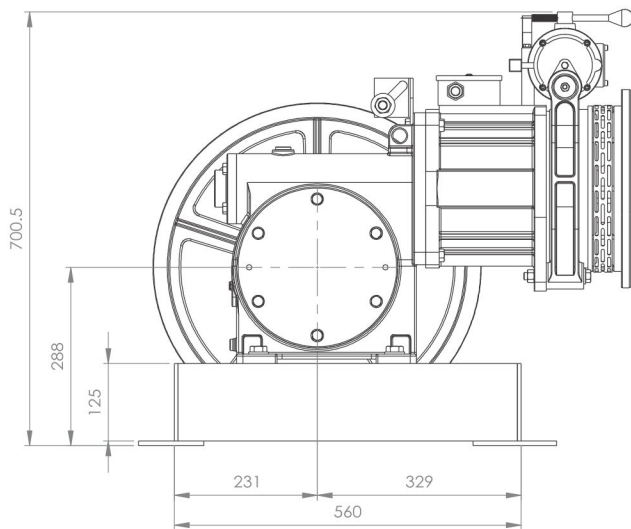
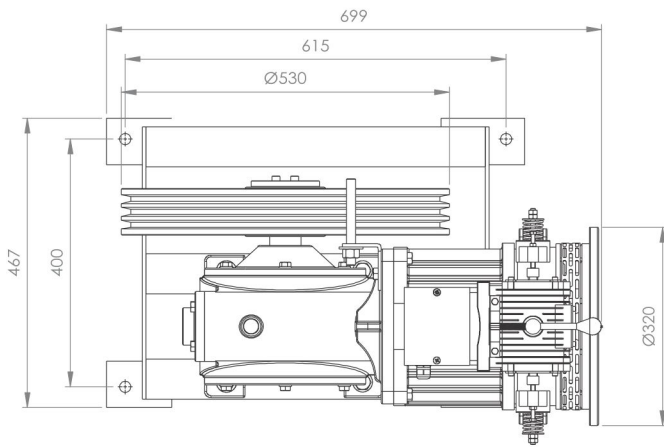
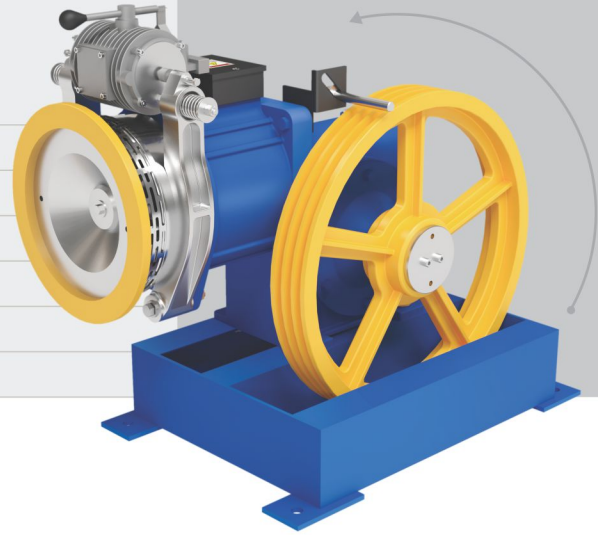

all dimensions are in mm.

Model	Load (in kg)	Speed (in m/sec)	Ratio	Sheave	Rope	Ropeing	Power (kW)	Power (HP)	Pole	Travel
VI 7.5 UT SMART	544	0.65	1/40	530	10/13 x 3/4	1:1	5.5	7.5	6	30
VI 7.5 UT SMART	544	1.00	1/40	530	10/13 x 3/4	1:1	5.5	7.5	4	30
VI 7.5 UT SMART	1000	0.65	1/40	530	10/13 x 3/4	2:1	5.5	7.5	4	26



GEARED  
**VI 7.5 UT** | **SUPER**

Max Static Load	3100 Kg.
Power Range	5.5. kW.
Brake Voltage	48, 60, 110, 220 DC.
Sheave Range	530, 560, 610 mm.
Oil Capacity	3.5 Ltr. (Approx)
Weight	275 Kg. (Approx)

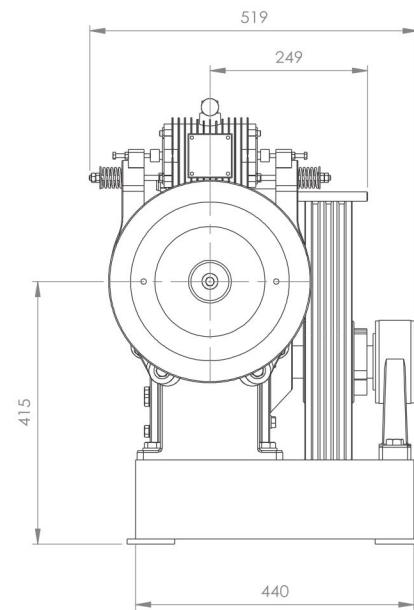
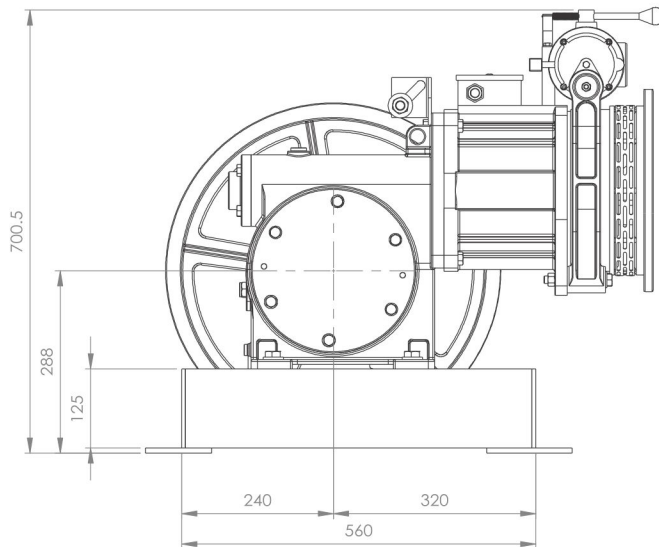
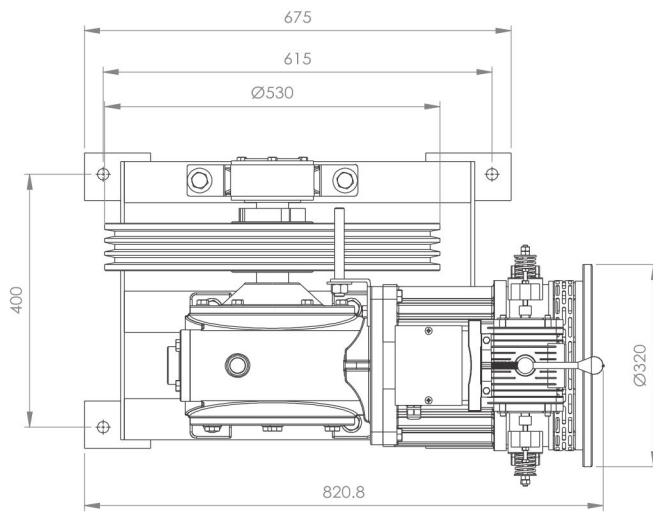
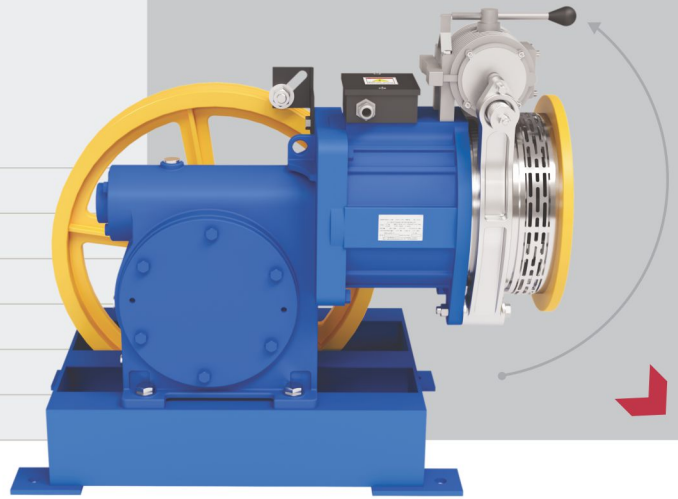

all dimensions are in mm.

Model	Load (in kg)	Speed (in m/sec)	Ratio	Sheave	Rope	Ropeing	Power (kW)	Power (HP)	Pole	Travel
VI 7.5 UT SUPER	544	0.65	1/40	530	10/13 x 3/4	1:1	5.5	7.5	6	30
VI 7.5 UT SUPER	544	1.00	1/40	530	10/13 x 3/4	1:1	5.5	7.5	4	30
VI 7.5 UT SUPER	1000	0.65	1/40	530	10/13 x 3/4	2:1	5.5	7.5	4	26

# GEARED VI10UT SMART-S

Max Static Load	3500 Kg.
Power Range	7.5 kW.
Brake Voltage	48, 60, 110, 220 DC.
Sheave Range	530, 560, mm.
Oil Capacity	3.5 Ltr. (Approx)
Weight	295 Kg. (Approx)

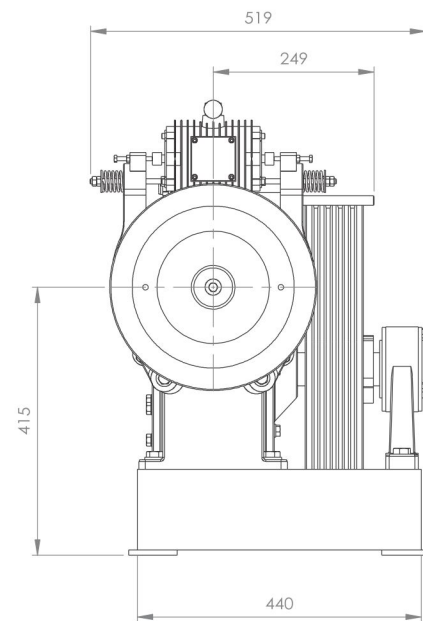
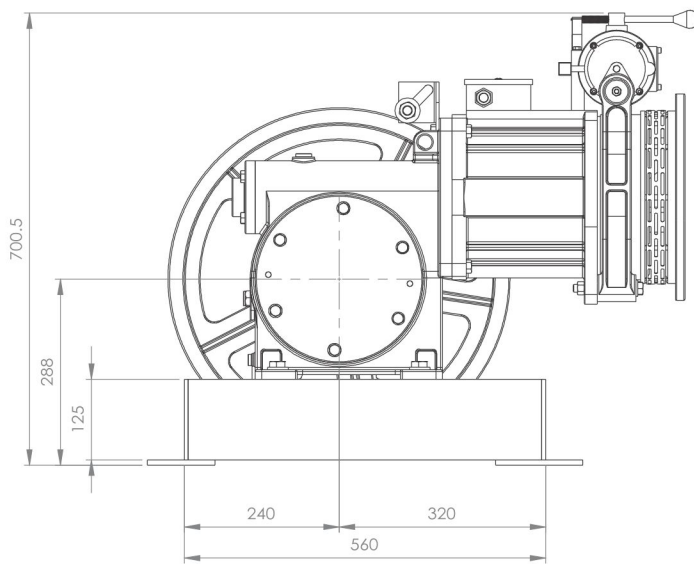
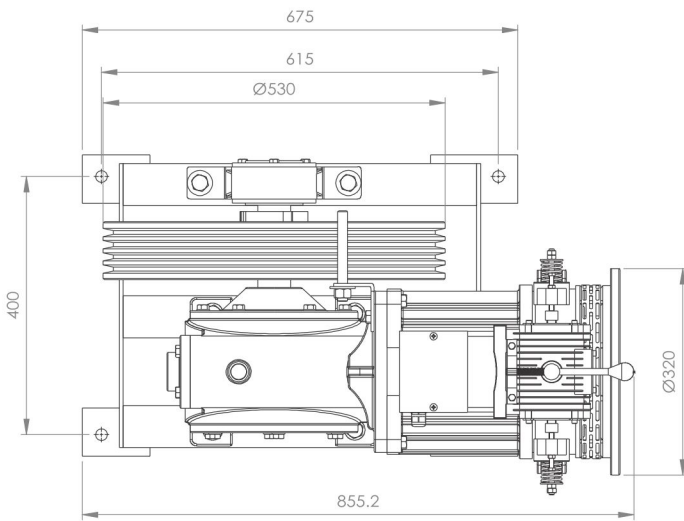
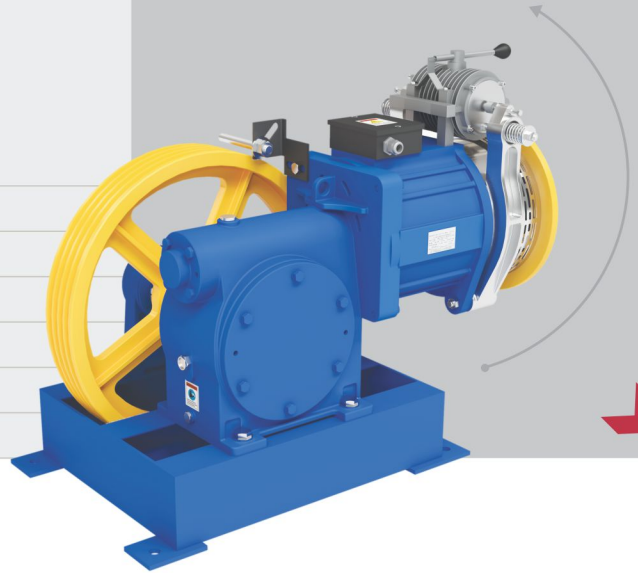

all dimensions are in mm.

Model	Load (in kg)	Speed (in m/sec)	Ratio	Sheave	Rope	Ropeing	Power (kW)	Power (HP)	Pole	Travel
VI 10 UT SMART	680	0.65	1/40	530	10/13 x 3/4	1:1	7.5	10	6	23
VI 10 UT SMART	680	1.00	1/40	530	10/13 x 3/4	1:1	7.5	10	4	23



GEARED  
**VI10UT SMART**

Max Static Load	3800 Kg.
Power Range	7.5 kW.
Brake Voltage	48, 60, 110, 220 DC.
Sheave Range	530, 560, 610 mm.
Oil Capacity	4.25 Ltr. (Approx)
Weight	310 Kg. (Approx)

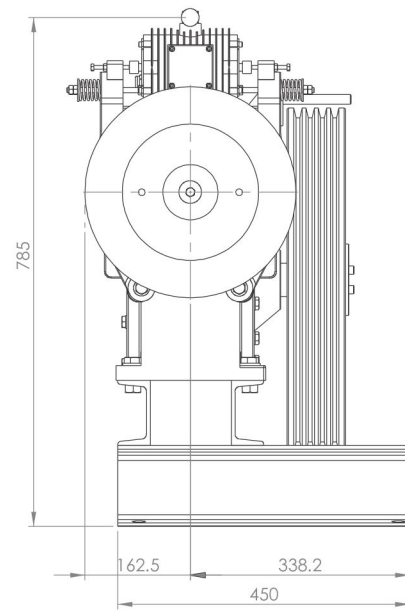
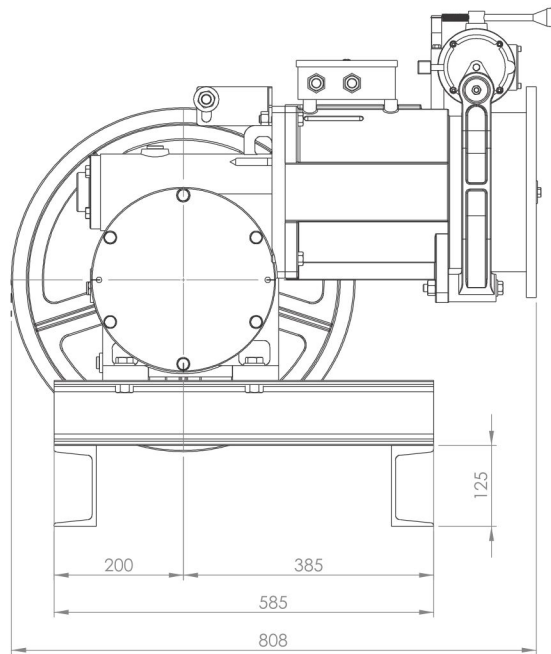
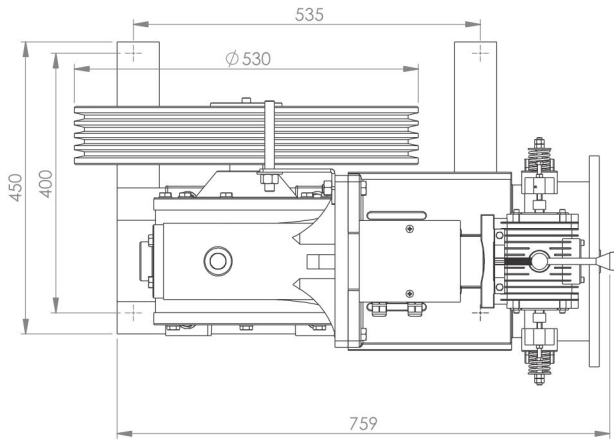
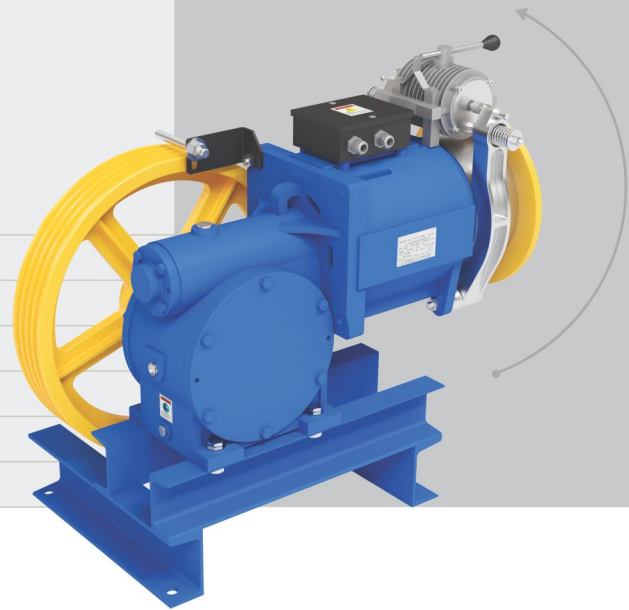

all dimensions are in mm.

Model	Load (in kg)	Speed (in m/sec)	Ratio	Sheave	Rope	Ropeing	Power (kW)	Power (HP)	Pole	Travel
VI 10 UT SMART	680	1.00	1/45	530	10/13 x 3/4	1:1	7.5	10	4	30
VI 10 UT SMART	1360	0.65	1/45	530	10/13 x 3/4	2:1	7.5	10	4	26

# GEARED VI10 UT SUPER

Max Static Load	3800 Kg.
Power Range	7.5 kW.
Brake Voltage	48, 60, 110, 220 DC.
Sheave Range	530, 560, 610 mm.
Oil Capacity	4.25 Ltr. (Approx)
Weight	320 Kg. (Approx)

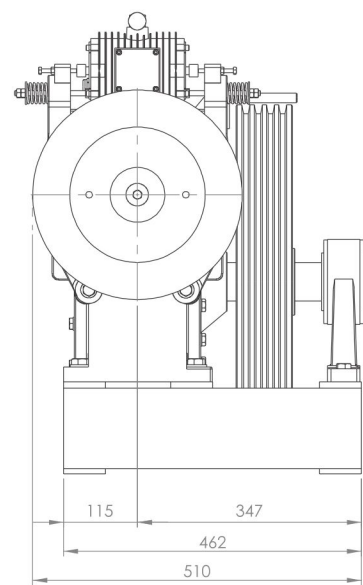
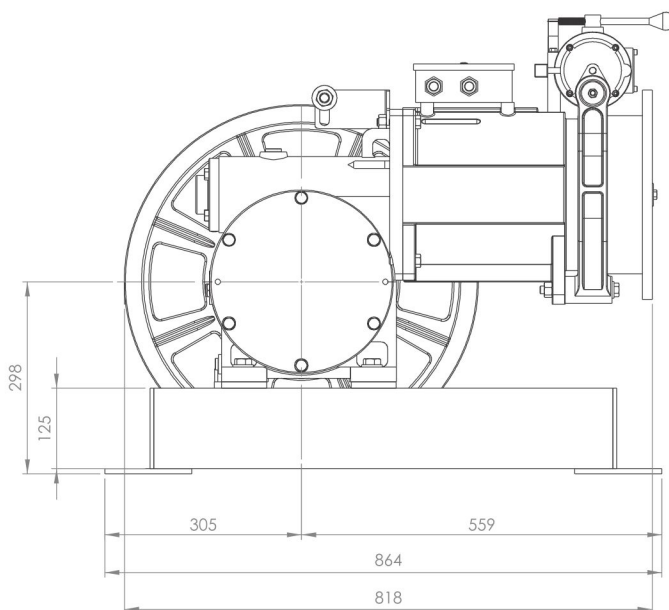
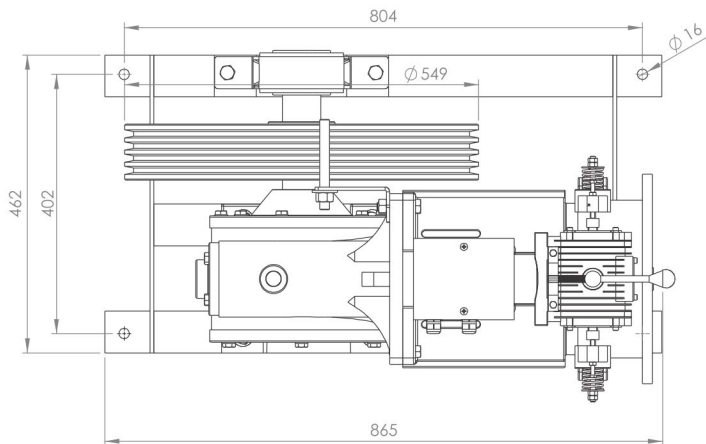
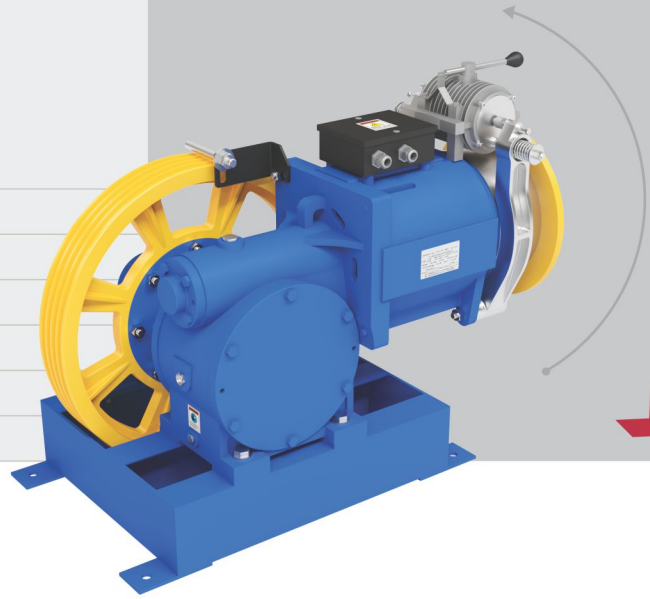

all dimensions are in mm.

Model	Load (in kg)	Speed (in m/sec)	Ratio	Sheave	Rope	Ropeing	Power (kW)	Power (HP)	Pole	Travel
VI 10 UT SUPER	680	1.00	1/45	530	10/13 x 3/4	1:1	7.5	10	4	30
VI 10 UT SUPER	1360	0.65	1/45	530	10/13 x 3/4	2:1	7.5	10	4	26



# GEARED VI15UT SMART

Max Static Load	5000 Kg.
Power Range	9.2 / 11 kW.
Brake Voltage	48, 60, 110, 220 DC.
Sheave Range	530, 560, 610 mm.
Oil Capacity	5 Ltr. (Approx)
Weight	350 Kg. (Approx)

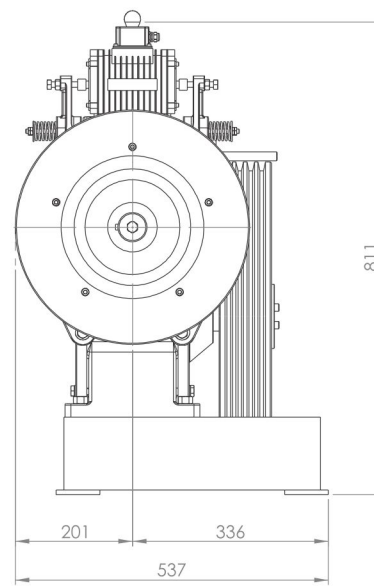
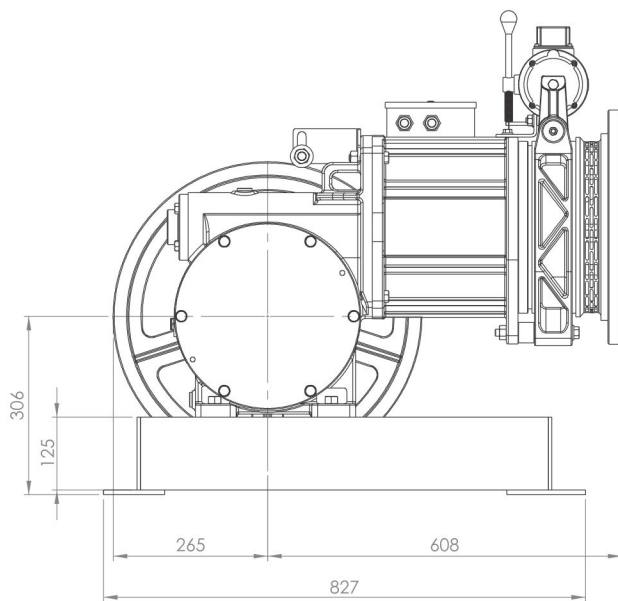
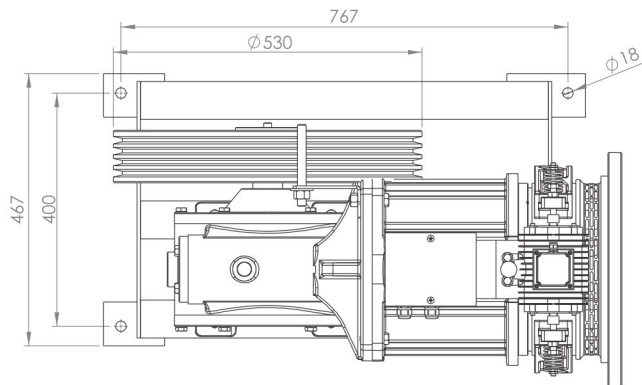
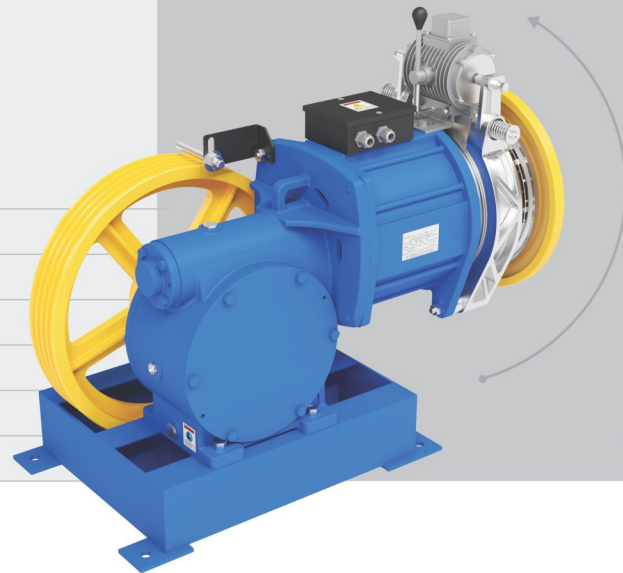

all dimensions are in mm.

Model	Load (in kg)	Speed (in m/sec)	Ratio	Sheave	Rope	Ropeing	Power (kW)	Power (HP)	Travel
VI 15 UT SMART	816	1.00	1/50	530	13 x 3/4	1:1	9.2	12.5	30
VI 15 UT SMART	1632	0.65	1/50	530	13 x 4/5	2:1	9.2	12.5	30
VI 15 UT SMART	1020	1.00	1/50	530	13 x 4/5	1:1	11.0	15	30
VI 15 UT SMART	2040	0.65	1/50	530	13 x 4/5	2:1	11.0	15	30

# GEARED VI15UT SUPER

Max Static Load	5000 Kg.
Power Range	9.2 / 11 kW.
Brake Voltage	48, 60, 110, 220 DC.
Sheave Range	530, 560, 610 mm.
Oil Capacity	5 Ltr. (Approx)
Weight	380 Kg. (Approx)

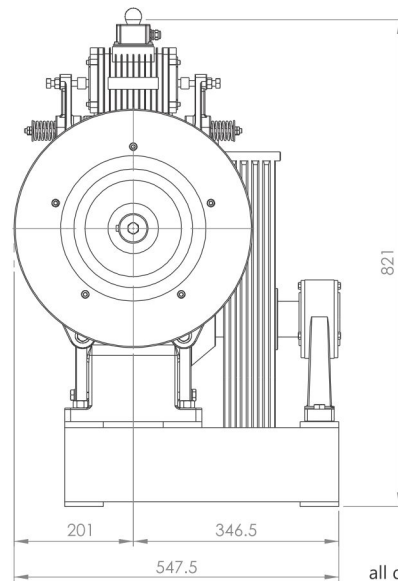
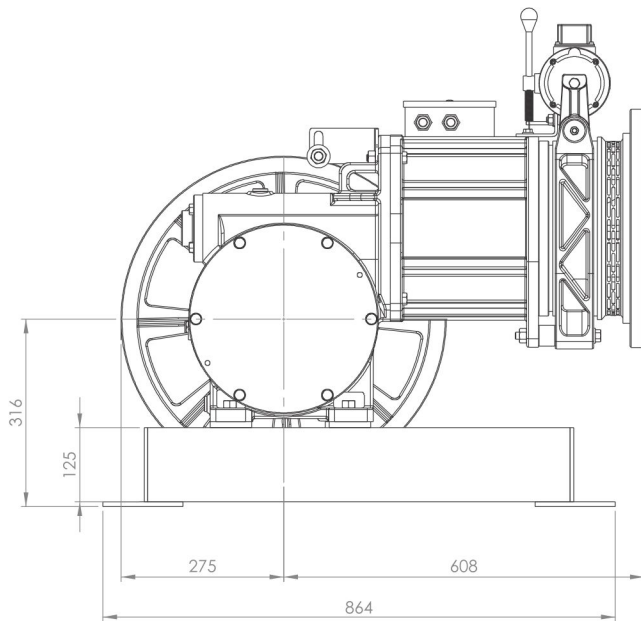
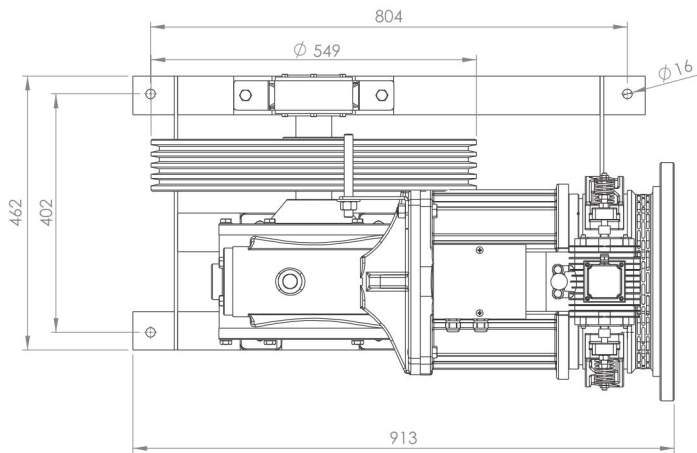
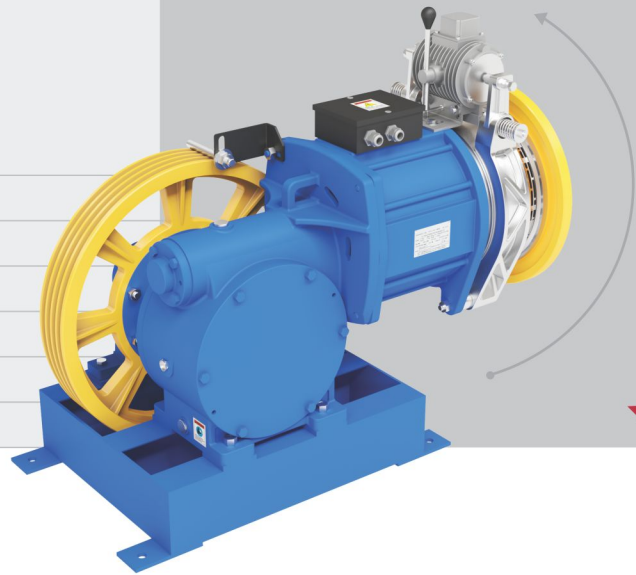

all dimensions are in mm.

Model	Load (in kg)	Speed (in m/sec)	Ratio	Sheave	Rope	Ropeing	Power (kW)	Power (HP)	Travel
VI 15 UT SUPER	816	1.00	1/50	530	13 x 3/4	1:1	9.2	12.5	30
VI 15 UT SUPER	1632	0.65	1/50	530	13 x 4/5	2:1	9.2	12.5	30
VI 15 UT SUPER	1020	1.00	1/50	530	13 x 4/5	1:1	11.0	15	30
VI 15 UT SUPER	2040	0.65	1/50	530	13 x 4/5	2:1	11.0	15	30



## VI20UT GEARED

Max Static Load	7000 Kg.
Power Range	15 kW.
Brake Voltage	48, 60, 110, 220 DC.
Sheave Range	610 mm.
Oil Capacity	7 Ltr. (Approx)
Weight	480 Kg. (Approx)

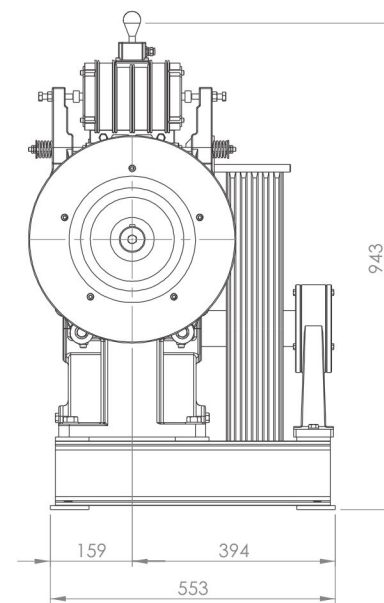
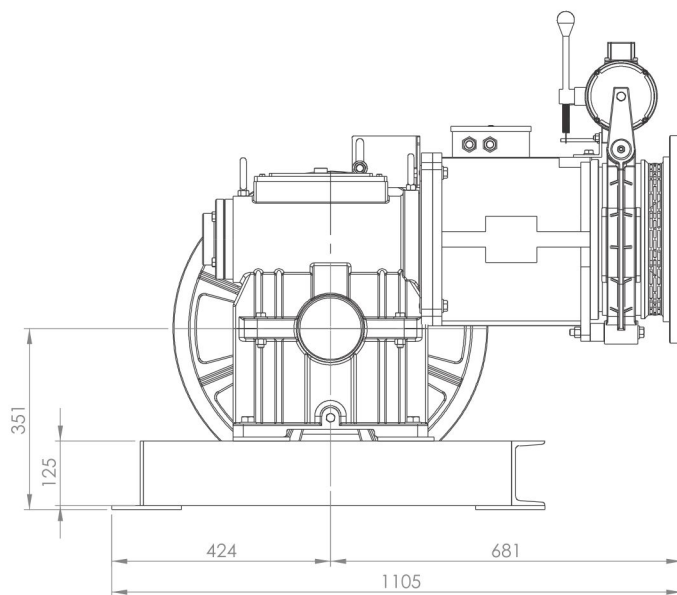
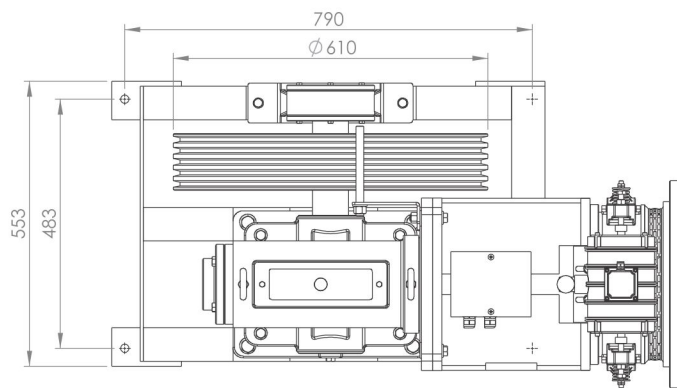
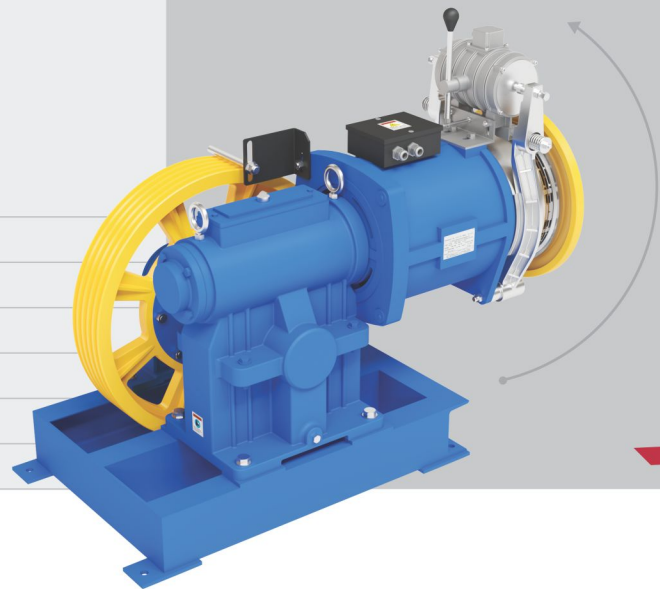

all dimensions are in mm.

Model	Load (in kg)	Speed (in m/sec)	Ratio	Sheave	Rope	Ropeing	Power (kW)	Power (HP)	Travel
VI 20 UT	1360	1.00	1/50	610	13 x 13/5	1:1	15	20	30
VI 20 UT	3000	1.00	1/50	610	13 x 13/5	2:1	15	20	30



## VI25UT GEARED

Max Static Load	8000 Kg.
Power Range	18.5 kW.
Brake Voltage	48, 60, 110, 220 DC.
Sheave Range	610 mm.
Oil Capacity	8 Ltr. (Approx)
Weight	600 Kg. (Approx)

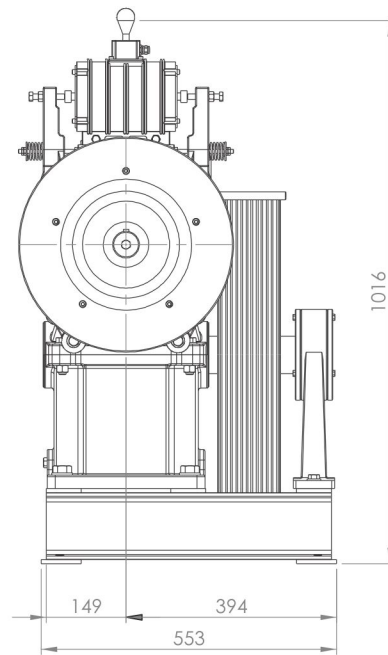
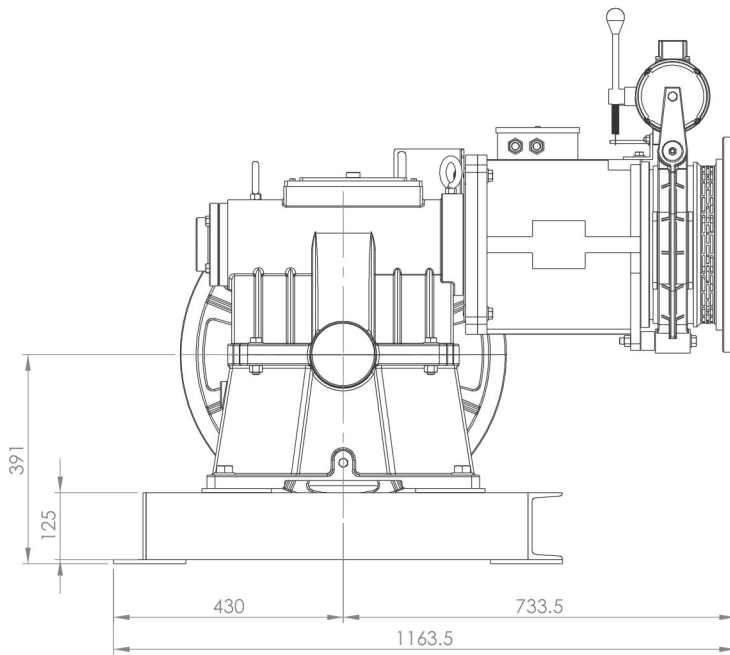
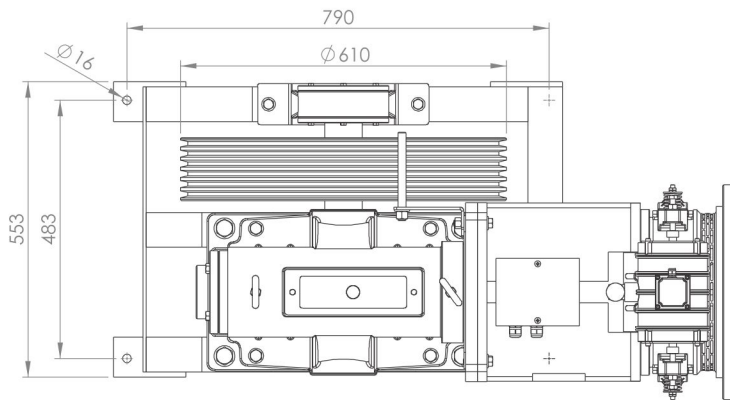
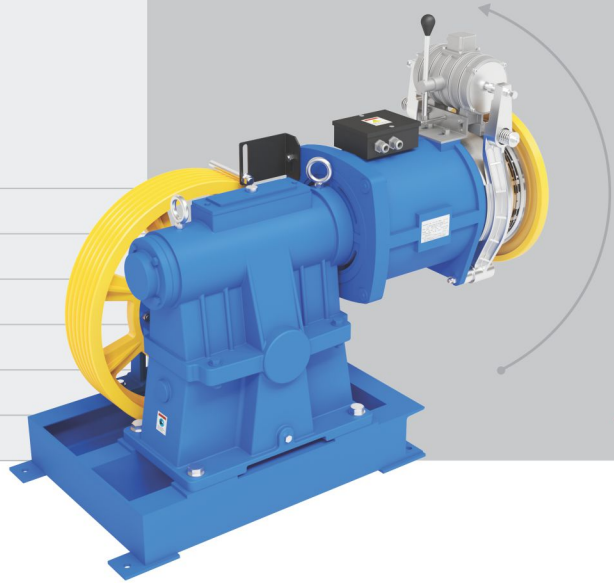

all dimensions are in mm.

Model	Load (in kg)	Speed (in m/sec)	Ratio	Sheave	Rope	Ropeing	Power (kW)	Power (HP)	Travel
VI 25 UT	4000	0.5	1/59	610	13 x 13/6/7	2:1	18.5	25	30



## PREMIUM SERIES

### VP53 GEARED

Max Static Load	3000 Kg.
Power Range	3, 3.7, 4.5 kW.
Brake Voltage	48, 60, 110, 220 DC.
Sheave Range	530 mm.
Oil Capacity	3 Ltr. (Approx)
Weight	240 Kg. (Approx)

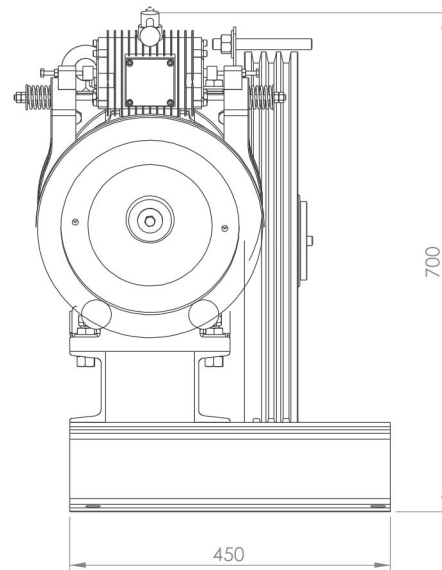
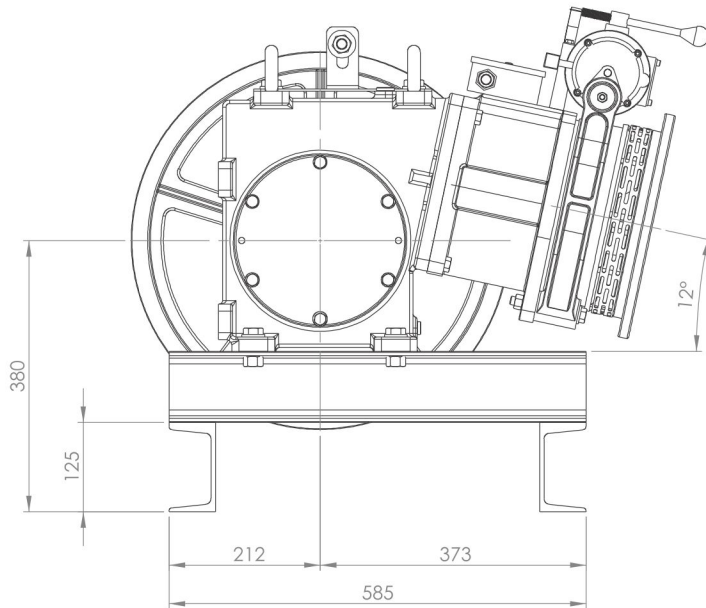
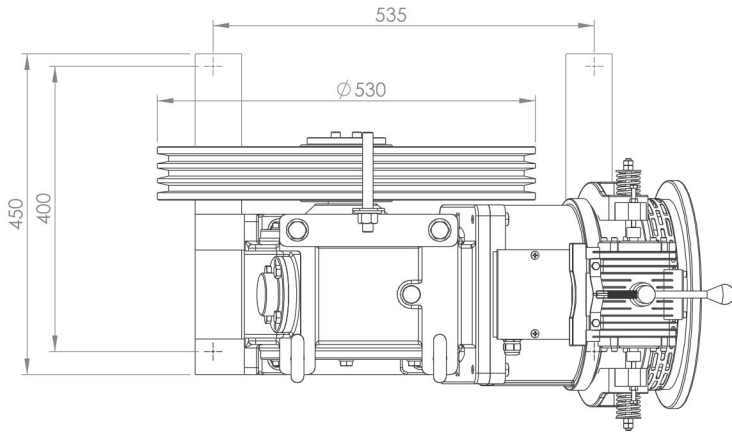
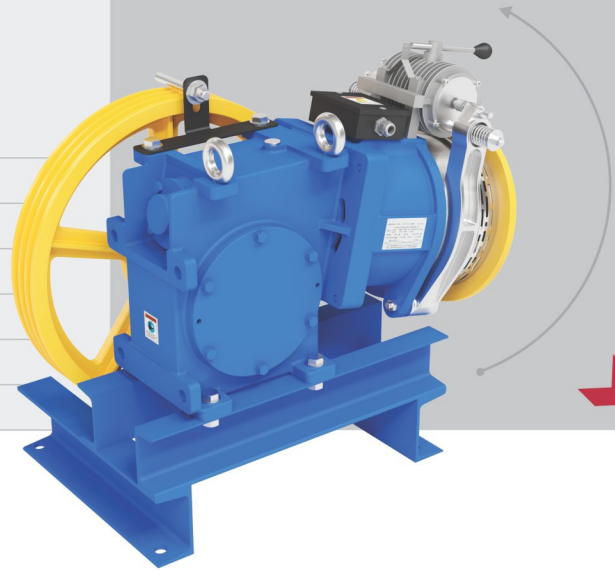

all dimensions are in mm.

Model	Load (in kg)	Speed (in m/sec)	Ratio	Sheave	Rope	Ropeing	Power (kW)	Power (HP)	Pole	Travel
VP 53	408	0.70	38/1	530	13 x 13/3	1:1	3.7	5	6	23
VP 53	544	0.35	38/1	530	13 x 13/3	2:1	3.7	5	6	21

# PREMIUM SERIES

## VP54 GEARED

Max Static Load	3100 Kg.
Power Range	5.5 kW.
Brake Voltage	48, 60, 110, 220 DC.
Sheave Range	530, 560, 610 mm.
Oil Capacity	3.5 Ltr. (Approx)
Weight	270 Kg. (Approx)

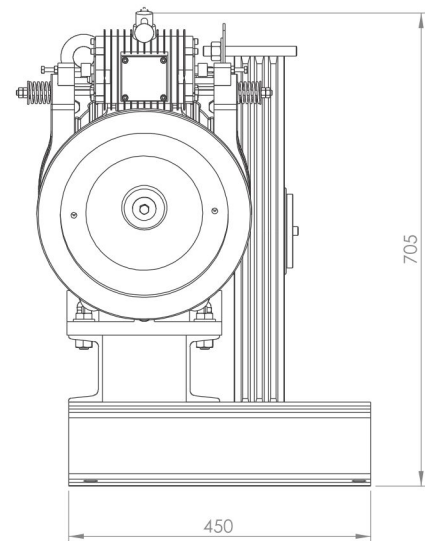
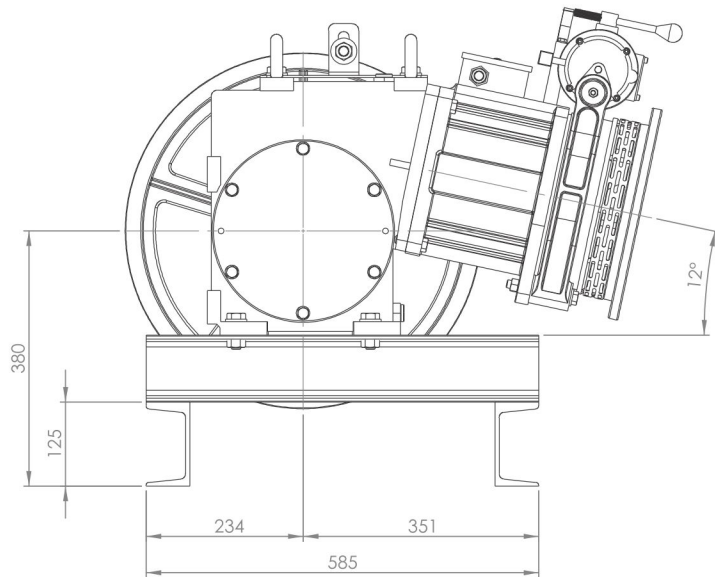
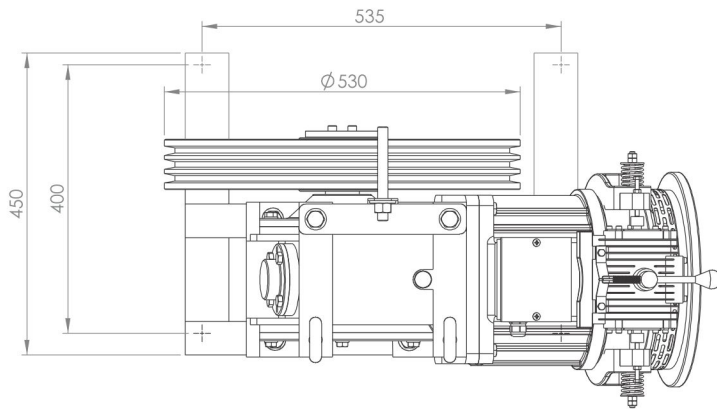
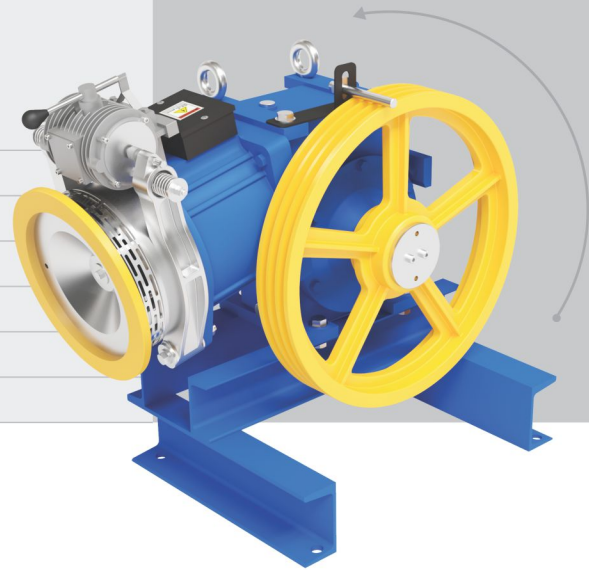

Model	Load (in kg)	Speed (in m/sec)	Ratio	Sheave	Rope	Ropeing	Power (kW)	Power (HP)	Pole	Travel
VP 54	544	0.65	1/40	530	10 x 13 x 3/4	1:1	5.5	7.5	6	30
VP 54	544	1.00	1/40	530	10 x 13 x 3/4	1:1	5.5	7.5	4	30
VP 54	1000	0.65	1/40	530	10 x 13 x 3/4	2:1	5.5	7.5	4	26



## PREMIUM SERIES

### VP55 GEARED

Max Static Load	3500 Kg.
Power Range	7.5 kW.
Brake Voltage	48, 60, 110, 220 DC.
Sheave Range	530, 560 mm.
Oil Capacity	3.5 Ltr. (Approx)
Weight	290 Kg. (Approx)

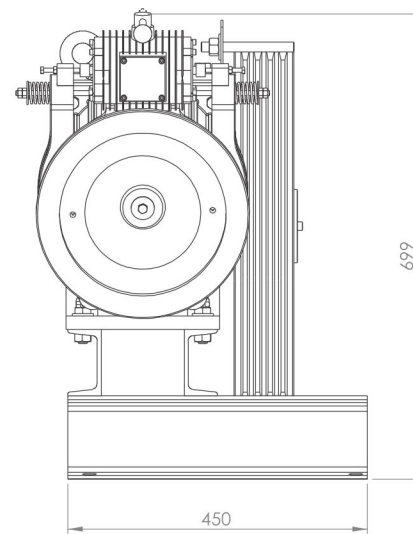
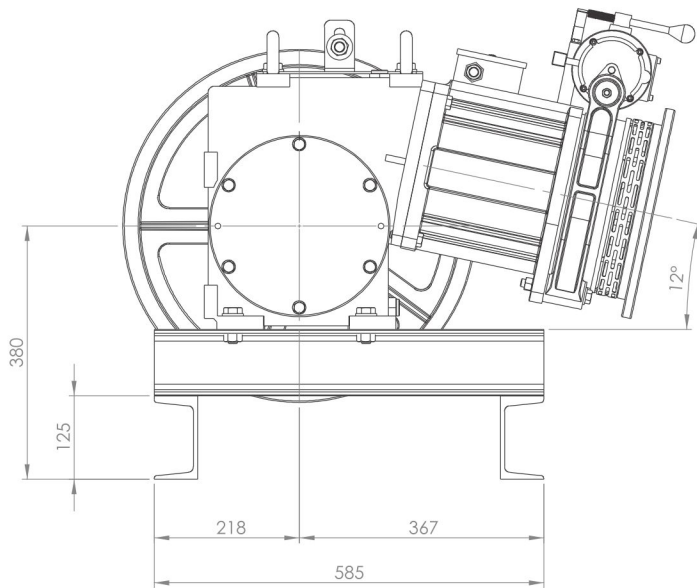
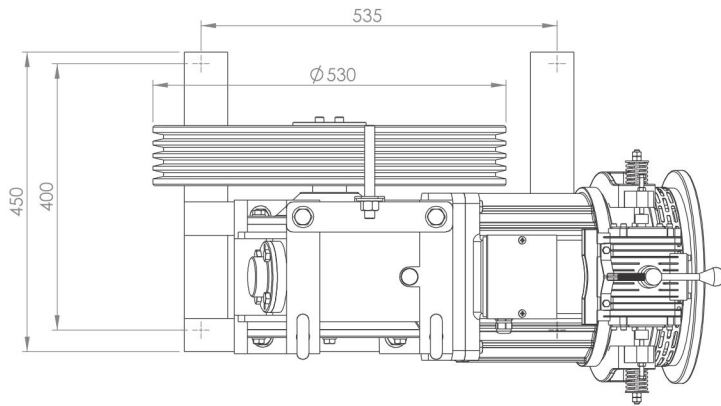
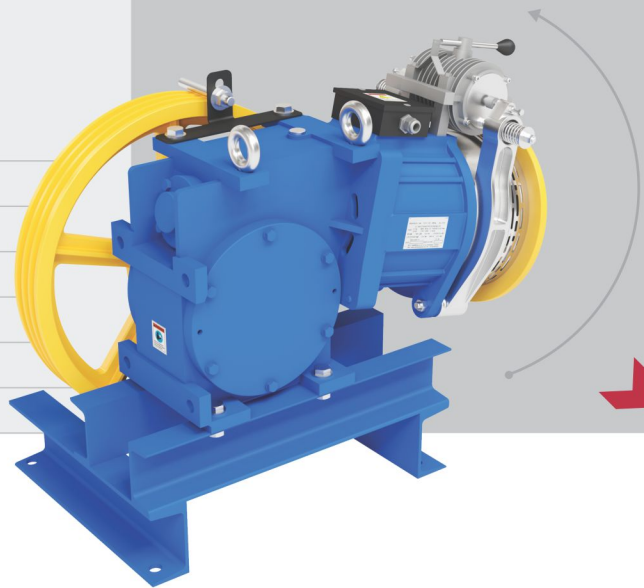

all dimensions are in mm.

Model	Load (in kg)	Speed (in m/sec)	Ratio	Sheave	Rope	Ropeing	Power (kW)	Power (HP)	Pole	Travel
VP 55	680	0.65	1/40	530	13 x 13 x 3/4	1:1	7.5	10	6	23
VP 55	680	1.00	1/40	530	13 x 13 x 3/4	1:1	7.5	10	4	23



DUMBWAITER  
**DR 06 DRUM TYPE**

Load Capacity	500 Kg.
Power Range	3.7 4.5 kW.
Brake Voltage	48, 60, 110, 220 DC.
Oil Capacity	3.5 Ltr. (Approx)
Weight	300 Kg. (Approx)

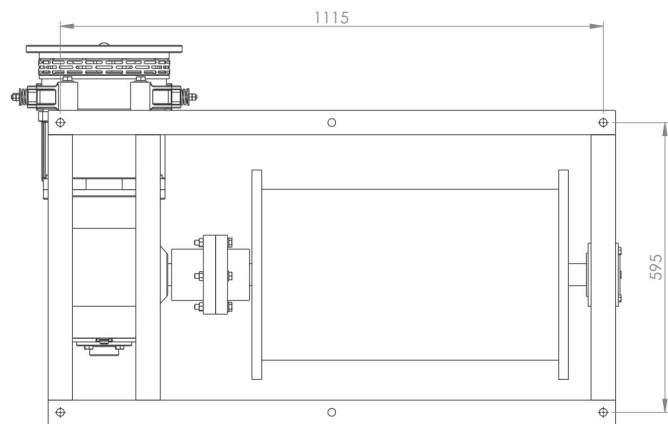
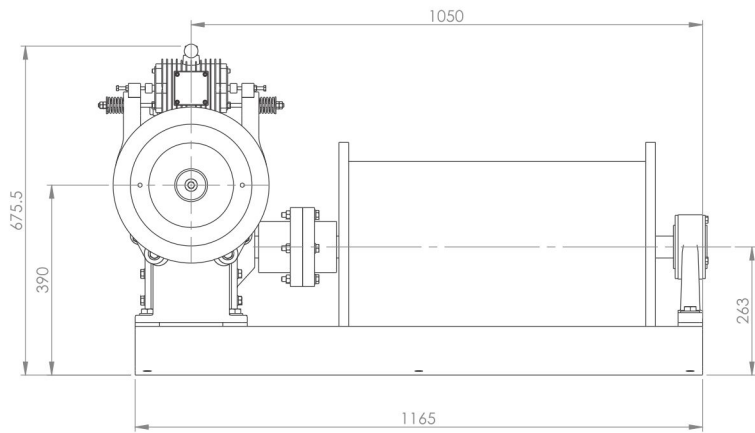
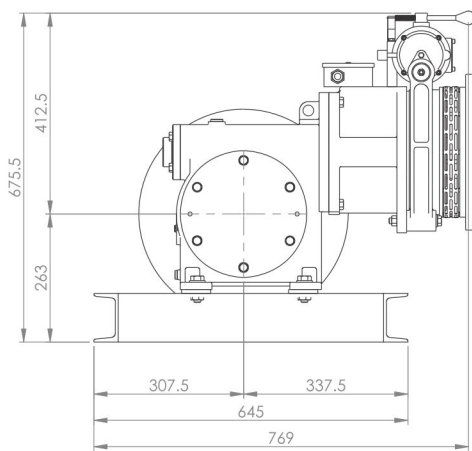
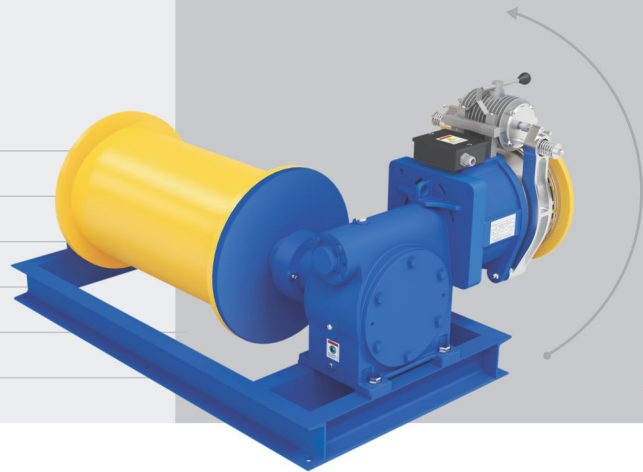

all dimensions are in mm.

Model	Load (in kg)	Ratio	Rope	Power (kW)	Power (HP)
DR 06	450	40:1	8 mm / 10 mm	3.7	5
DR 06	500	40:1	8 mm / 10mm	4.5	6



DUMBWAITER  
**DR 08** DRUM TYPE

Load Capacity	750, 1000 Kg.
Power Range	5.5, 7.5 kW.
Brake Voltage	48, 60, 110, 220 DC.
Oil Capacity	4 Ltr. (Approx)
Weight	320 Kg. (Approx)

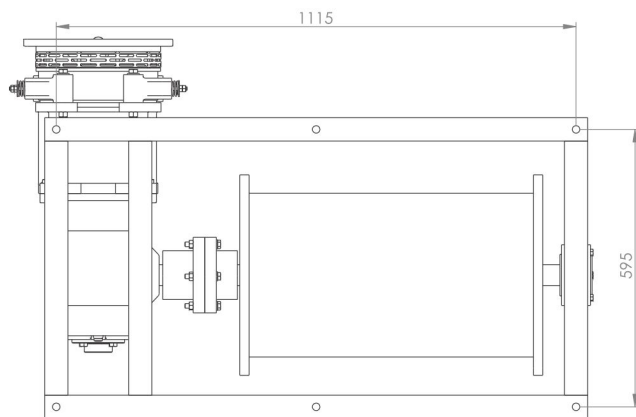
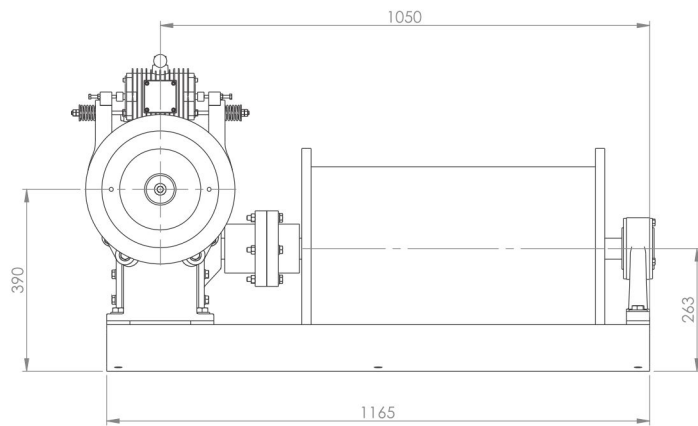
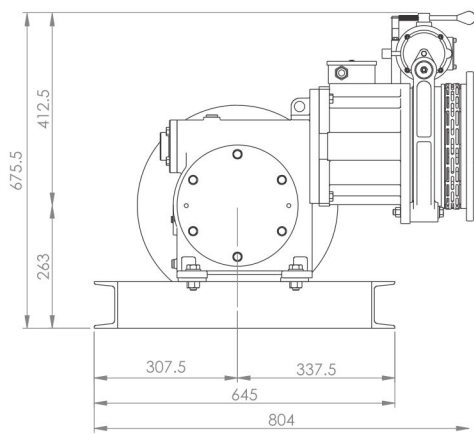
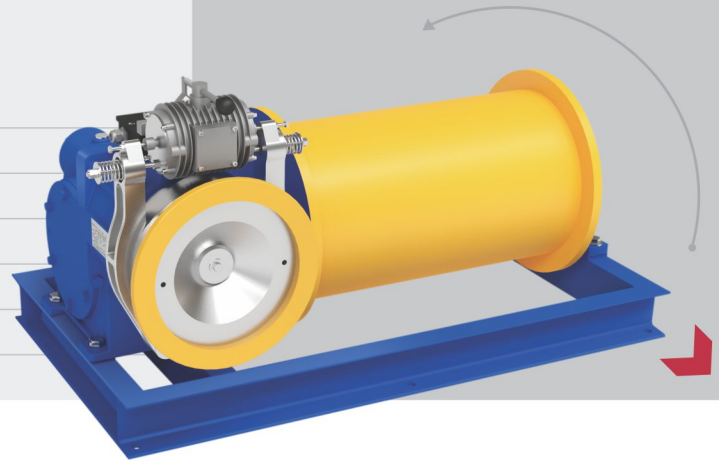

all dimensions are in mm.

Model	Load (in kg)	Ratio	Rope	Power (kW)	Power (HP)
DR 08	750	40:1	8 mm / 10 mm	5.5	7.5
DR 08	1000	40:1	8 mm / 10mm	7.5	10



DUMBWAITER  
**DR10 DRUM TYPE**

Load Capacity	1500 Kg.
Power Range	11 kW.
Brake Voltage	48, 60, 110, 220 DC.
Oil Capacity	5 Ltr. (Approx)
Weight	350 Kg. (Approx)

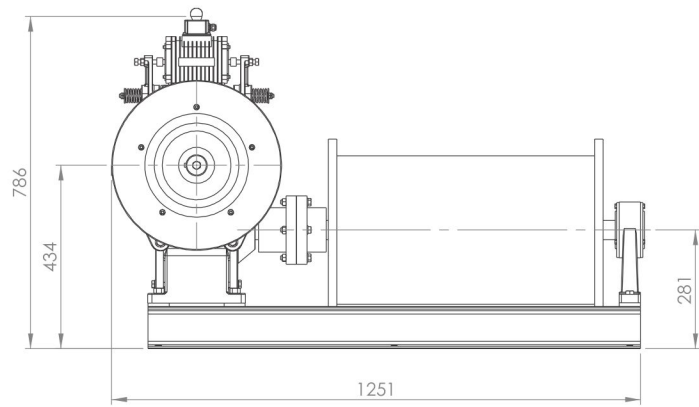
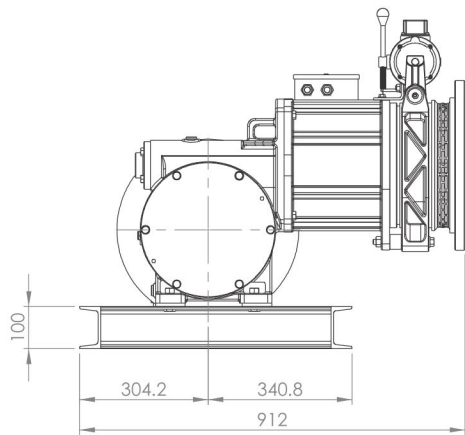
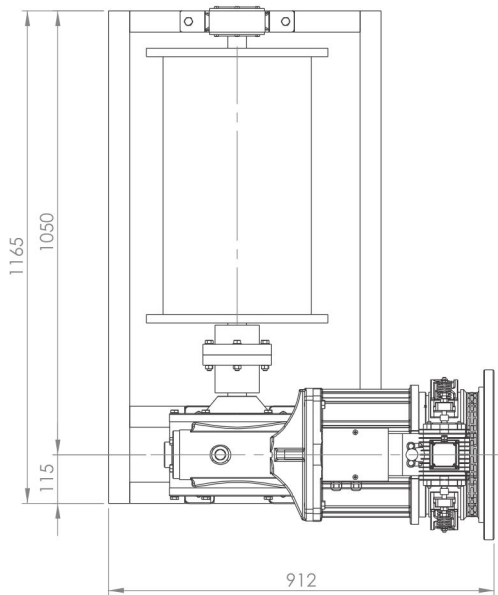
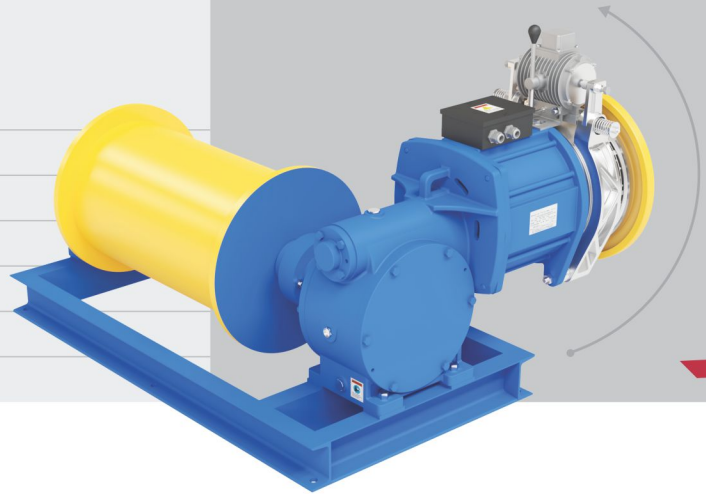

all dimensions are in mm.

Model	Load (in kg)	Ratio	Rope	Power (kW)	Power (HP)
DR 10	1500	50:1	10 mm / 13 mm	11	15



Technology  
Collaboration by  
Italy



## Easily Accessible

# Permanent magnet synchronous gearless traction m/c.

We choose rare earth material and fully combine coaxial transmission technology and digital variable frequency technology with group computer combined control technology. Compared with the ordinary and traditional technology, gearless traction machine has the characteristics of lowest running cost and low heat loss and it can save more than 30% of the energy. Gearless traction machine needs no renewal of grease. It has no oil spill pollution and low noise. It is quiet and natural.



No Machine Room  
Require



Save Energy



Low Noise



Compact Designs





## GEARLESS VL 500 10S

**VERMEC**  
ELEVATOR GEARLESS MACHINE

Max Static Load	2000 Kg.
Voltage	400 V
Roping	2/1
Brake	110 V DC
Weight	120 Kg. (Approx)

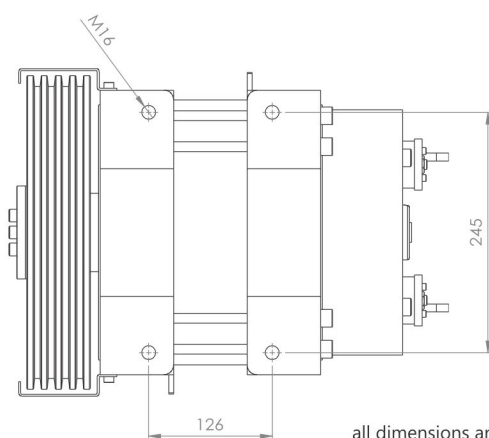
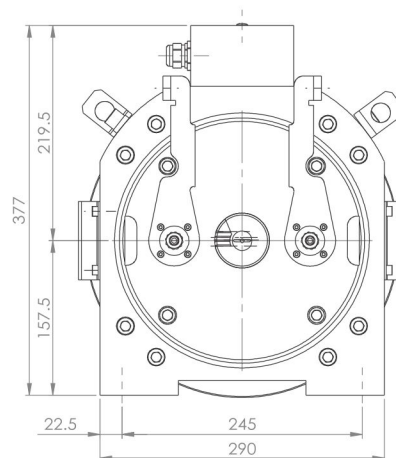
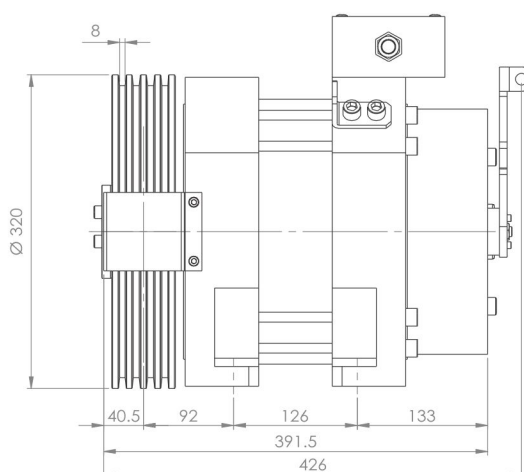
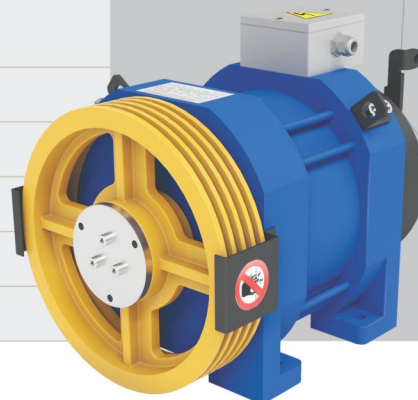

all dimensions are in mm.

Model	Load (in kg)	Roping	Speed (in m/sec)	Height (m)	Sheave (mm)	Rope (mm)	No. of Groove	Power (kW)	Amp	Rating	INS Class	IP Class
VL 500 10S	272	2/1	0.5	≤30	Ø200	8	4	1.9	6.0	S5 (40%)	F Class	IP-40
VL 500 10S	272	2/1	1.0	≤30	Ø240	8	4	2.0	6.7	S5 (40%)	F Class	IP-40
VL 500 10S	272	2/1	1.0	≤30	Ø320	8	4	2.0	6.7	S5 (40%)	F Class	IP-40



## GEARLESS VL1000 05S

Max Static Load	2000 Kg.
Voltage	230 V
Roping	2/1
Brake	110 V DC
Weight	118 Kg. (Approx)

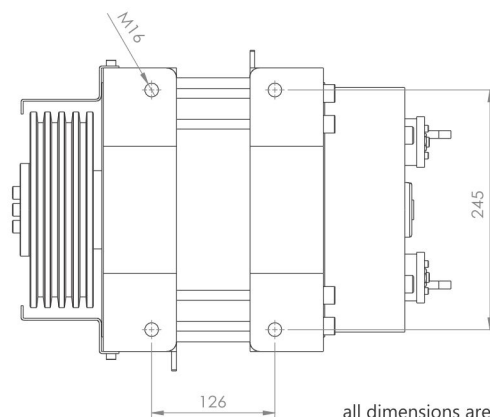
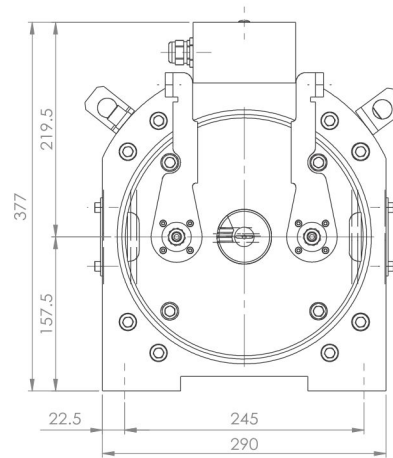
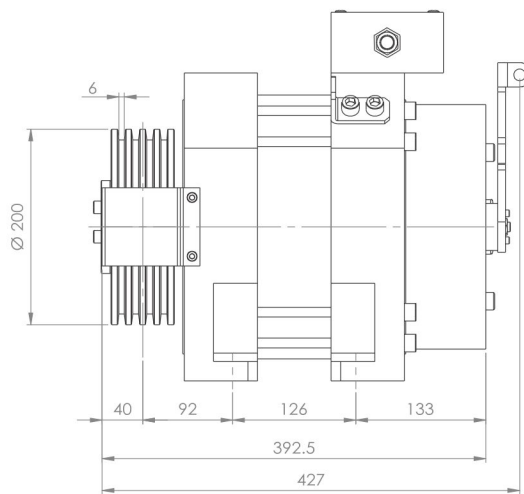

all dimensions are in mm.

Model	Load (in kg)	Roping	Speed (in m/sec)	Height (m)	Sheave (mm)	Rope (mm)	No. of Groove	Power (kW)	Amp	Rating	INS Class	IP Class
VL 1000 05S	408	2/1	0.5	≤20	Ø200	6	4	1.3	5.5	S5 (40%)	F Class	IP-40



GEARLESS  
**VL 1000 10S-N1**



Max Static Load	2800 Kg.
Voltage	400 V
Roping	2/1
Brake	110 V DC
Weight	135 Kg. (Approx)

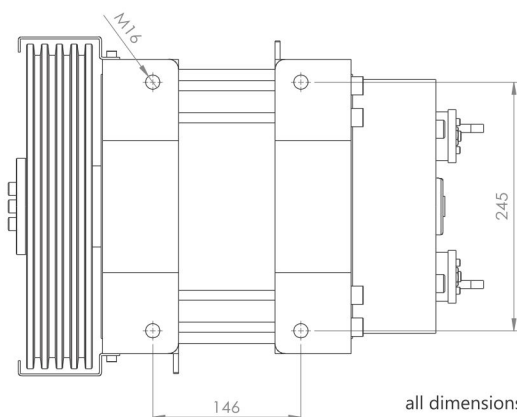
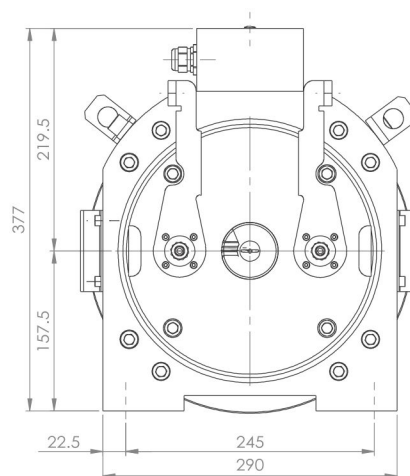
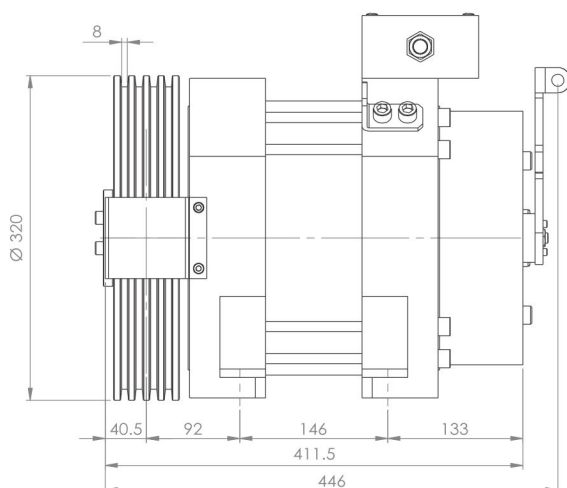

all dimensions are in mm.

Model	Load (in kg)	Roping	Speed (in m/sec)	Height (m)	Sheave (mm)	Rope (mm)	No. of Groove	Power (kW)	Amp	Rating	INS Class	IP Class
VL 1000 10S	408	2/1	0.7	≤30	Ø200	8	4	2.4	7.5	S5 (40%)	F Class	IP-40
VL 1000 10S	408	2/1	1.0	≤30	Ø240	8	4	2.6	8.5	S5 (40%)	F Class	IP-40
VL 1000 10S	408	2/1	1.0	≤30	Ø320	8	4	2.6	8.5	S5 (40%)	F Class	IP-40



GEARLESS  
**VL 1000 10S-N2**

Max Static Load	3400 Kg.
Voltage	400 V
Roping	2/1
Brake	110 V DC
Weight	147 Kg. (Approx)

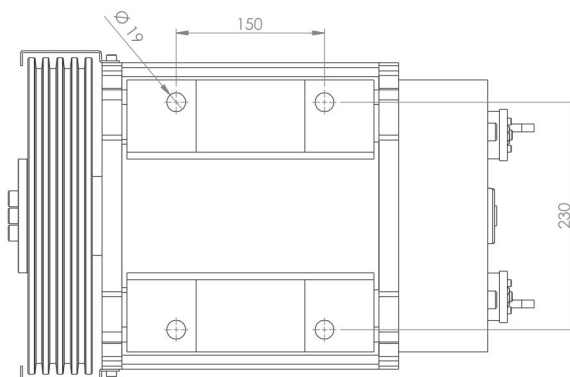
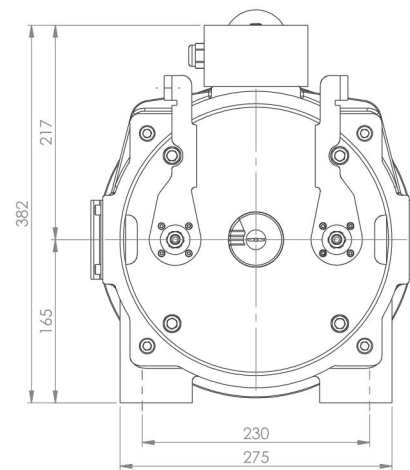
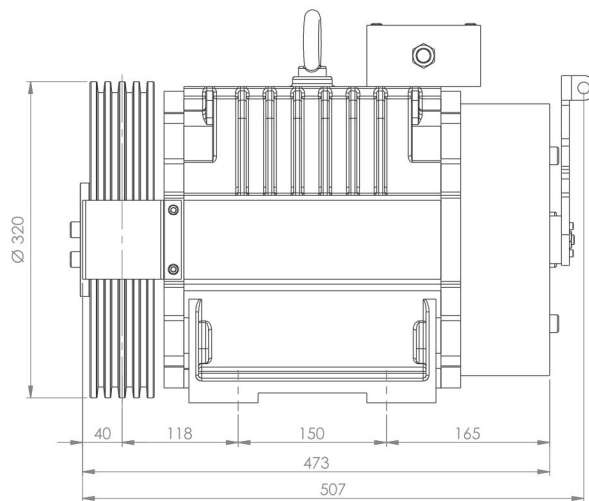

all dimensions are in mm.

Model	Load (in kg)	Roping	Speed (in m/sec)	Height (m)	Sheave (mm)	Rope (mm)	No. of Groove	Power (kW)	Amp	Rating	INS Class	IP Class
VL 1000 10S	450	2/1	1.0	≤60	Ø320	8	4	3.0	8.8	S5 (40%)	F Class	IP-40
VL 1000 10S	408	2/1	1.5	≤60	Ø320	8	4	4.2	9.8	S5 (40%)	F Class	IP-40
VL 1000 10S	408	2/1	1.75	≤60	Ø320	8	4	5.1	12.8	S5 (40%)	F Class	IP-40



# GEARLESS VL 1500 10S



Max Static Load	3400 Kg.
Voltage	400 V
Roping	2/1
Brake	110 V DC
Weight	168 Kg. (Approx)

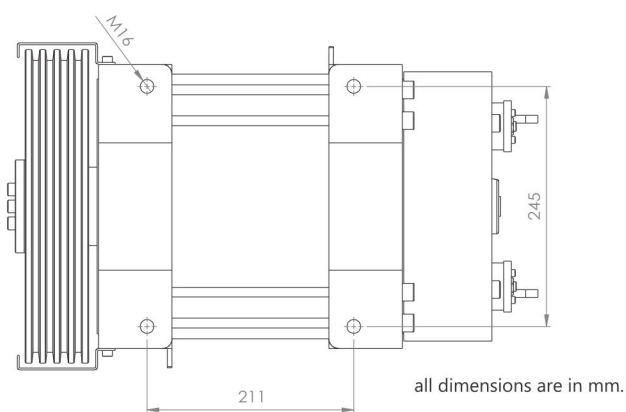
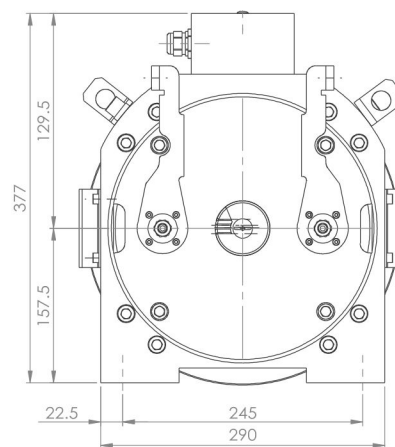
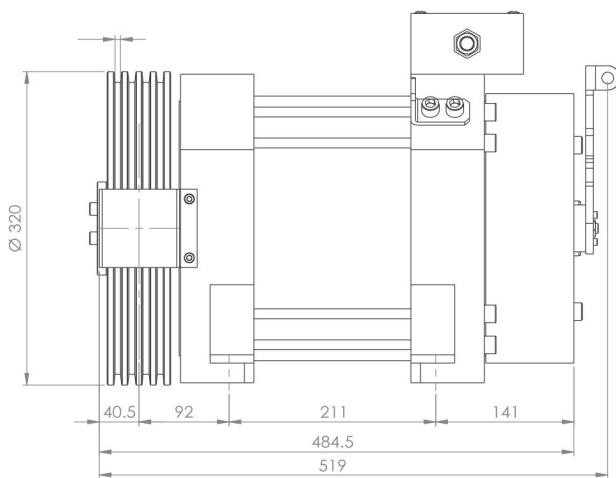

Model	Load (in kg)	Roping	Speed (in m/sec)	Height (m)	Sheave (mm)	Rope (mm)	No. of Groove	Power (kW)	Amp	Rating	INS Class	IP Class
VL 1500 10S	544	2/1	1.0	≤60	Ø240	8	4	3.8	9.5	S5 (40%)	F Class	IP-40
VL 1500 10S	544	2/1	1.0	≤60	Ø320	8	4	3.8	9.6	S5 (40%)	F Class	IP-40
VL 1500 10S	544	2/1	1.5	≤60	Ø320	8	4/5	5.6	13.0	S5 (40%)	F Class	IP-40
VL 1500 10S	544	2/1	1.75	≤60	Ø320	8	4/5	6.6	17.0	S5 (40%)	F Class	IP-40



## GEARLESS VL 2000 10S

Max Static Load	3400 Kg.
Voltage	400 V
Roping	2/1
Brake	110 V DC
Weight	177 Kg. (Approx)

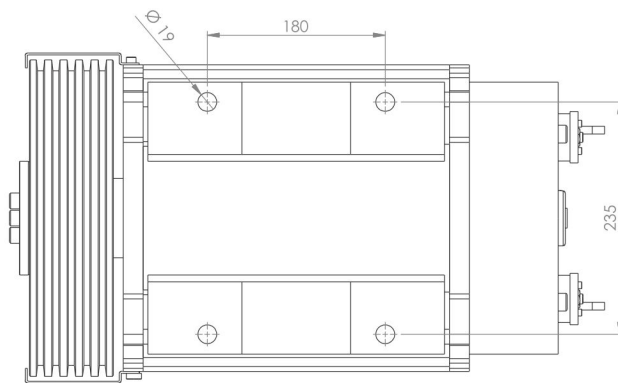
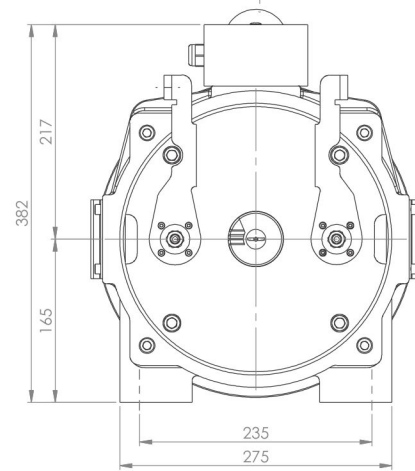
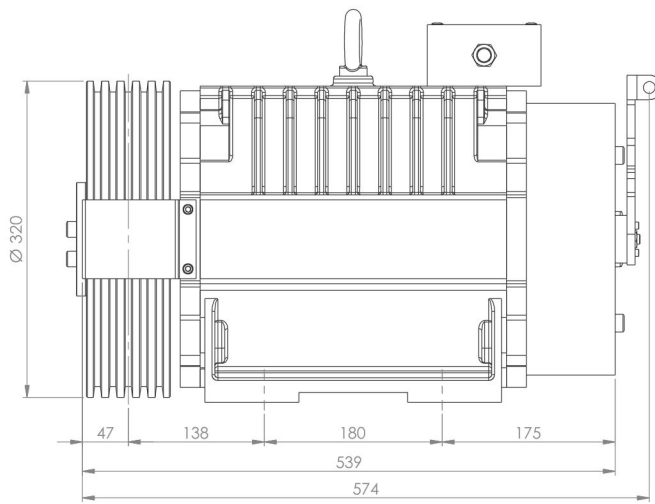
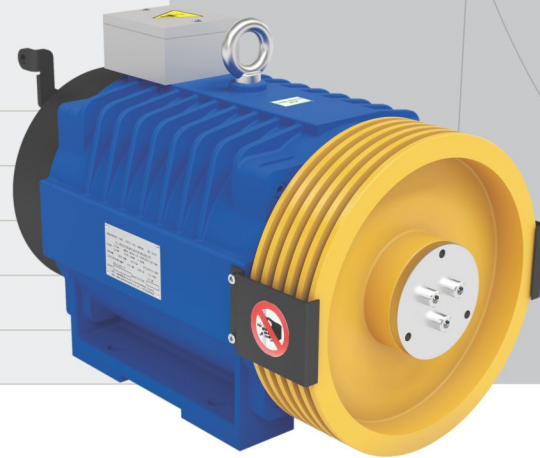

all dimensions are in mm.

Model	Load (in kg)	Roping	Speed (in m/sec)	Height (m)	Sheave (mm)	Rope (mm)	No. of Grove	Power (kW)	Amp	Rating	INS Class	IP Class
VL 2000 10S	680	2/1	1.0	≤80	Ø240	8	5	4.7	12.3	S5 (40%)	F Class	IP-40
VL 2000 10S	680	2/1	1.0	≤80	Ø320	8	5	4.7	12.4	S5 (40%)	F Class	IP-40
VL 2000 10S	680	2/1	1.5	≤80	Ø320	8	5/6	6.9	17.0	S5 (40%)	F Class	IP-40
VL 2000 10S	680	2/1	1.75	≤80	Ø320	8	6	8.2	21.0	S5 (40%)	F Class	IP-40



GEARLESS  
**VL 2300 10S**



Max Static Load	3400 Kg.
Voltage	400 V
Roping	2/1
Brake	110 V DC
Weight	185 Kg. (Approx)

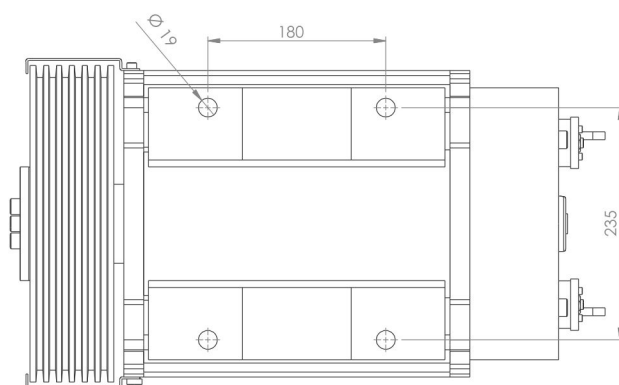
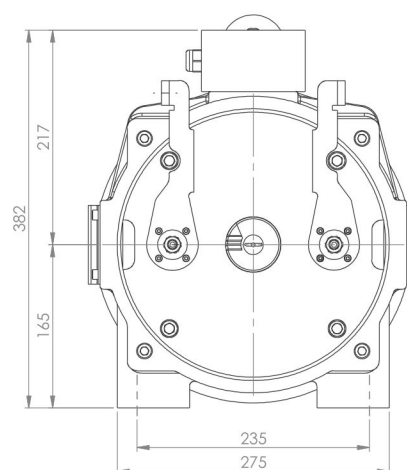
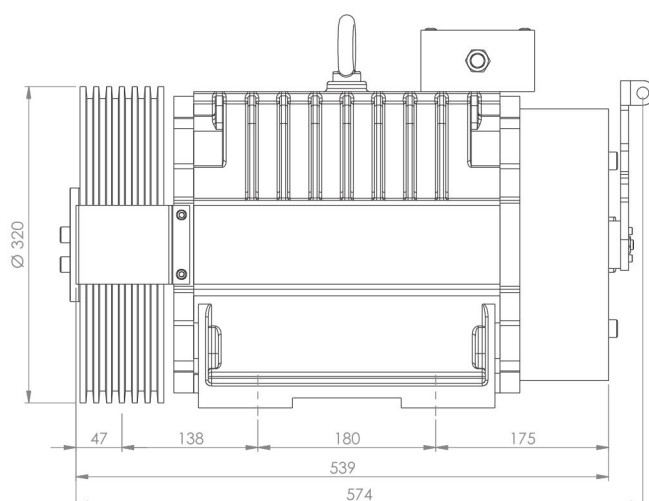
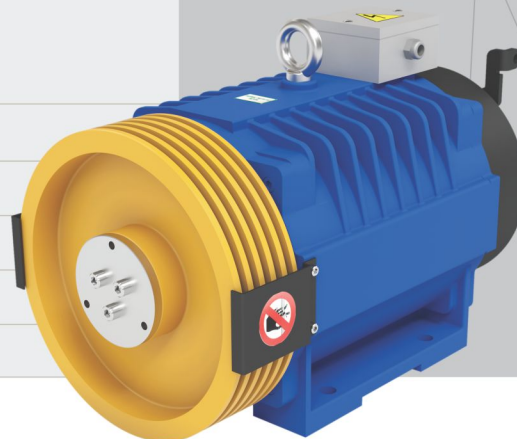

all dimensions are in mm.

Model	Load (in kg)	Roping	Speed (in m/sec)	Height (m)	Sheave (mm)	Rope (mm)	No. of Groove	Power (kW)	Amp	Rating	INS Class	IP Class
VL 2300 10S	884	2/1	1.0	≤60	Ø240	8	6	6.7	17.0	S5 (40%)	F Class	IP-40
VL 2300 10S	884	2/1	1.0	≤60	Ø320	8	6	6.7	17.2	S5 (40%)	F Class	IP-40



## GEARLESS VL 2500 10S

Max Static Load	4800 Kg.
Voltage	400 V
Roping	2/1
Brake	110 V DC
Weight	255 Kg. (Approx)

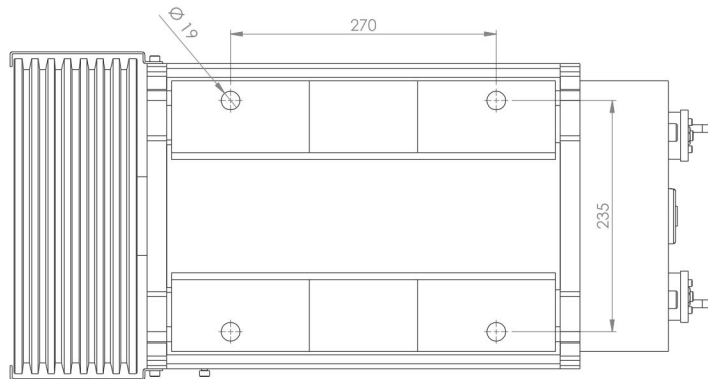
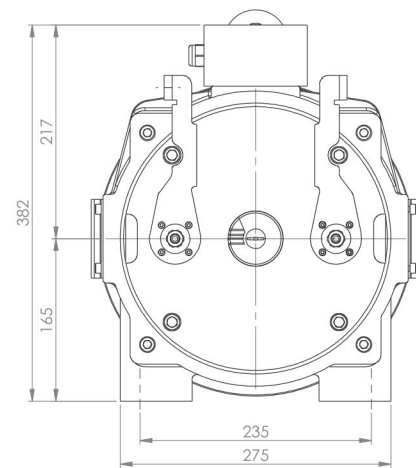
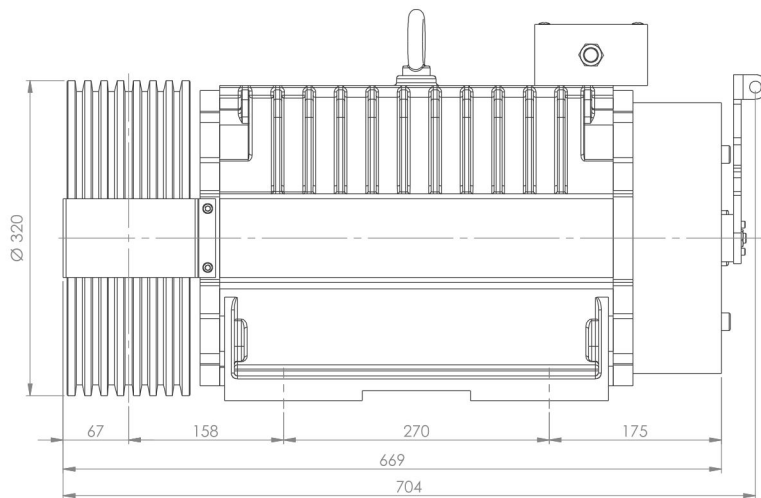

all dimensions are in mm.

Model	Load (in kg)	Roping	Speed (in m/sec)	Height (m)	Sheave (mm)	Rope (mm)	No. of Groove	Power (kW)	Amp	Rating	INS Class	IP Class
VL 2500 10S	1088	2/1	1.0	≤80	Ø320	8	7	7.3	20.0	S5 (40%)	F Class	IP-40
VL 2500 10S	1088	2/1	1.5	≤80	Ø320	8	7	10.9	25.0	S5 (40%)	F Class	IP-40
VL 2500 10S	1088	2/1	1.75	≤80	Ø320	8	7	12.8	28.5	S5 (40%)	F Class	IP-40



GEARLESS  
**VL2700**10S



Max Static Load	4800 Kg.
Voltage	400 V
Roping	2/1
Brake	110 V DC
Weight	268 Kg. (Approx)

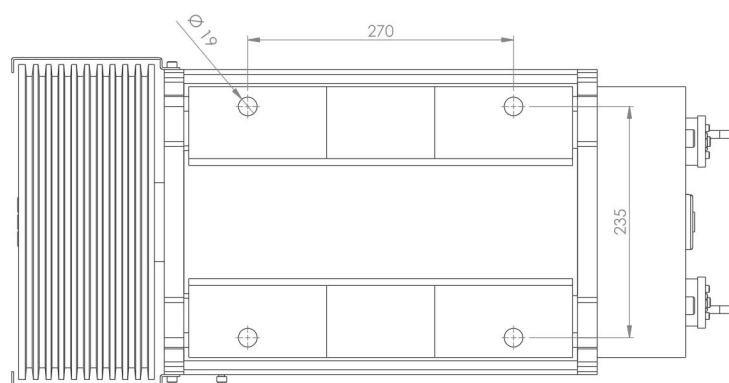
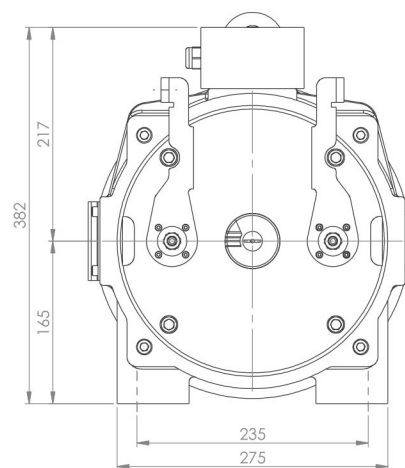
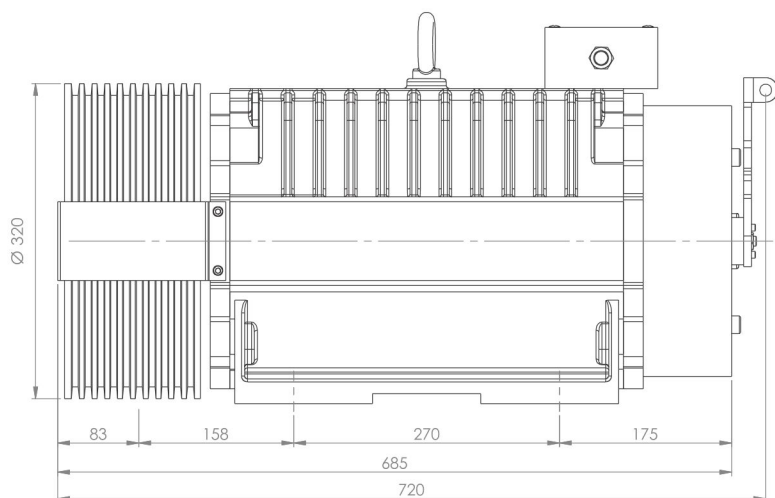
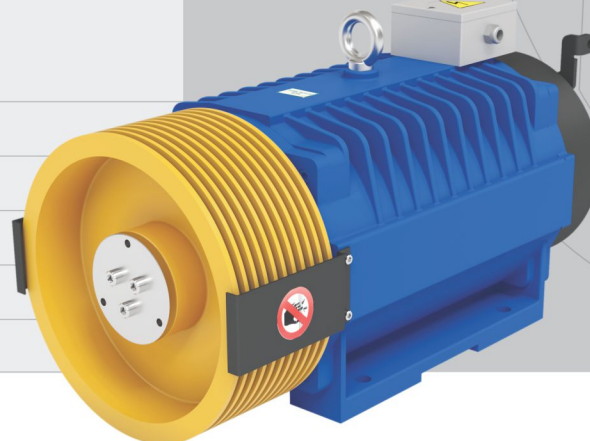

all dimensions are in mm.

Model	Load (in kg)	Roping	Speed (in m/sec)	Height (m)	Sheave (mm)	Rope (mm)	No. of Groove	Power (kW)	Amp	Rating	INS Class	IP Class
VL <b>2700</b> 10S	1360	2/1	1.0	≤80	Ø320	8	8	9.0	25.7	S5 (40%)	F Class	IP-40
VL <b>2700</b> 10S	1360	2/1	1.5	≤80	Ø320	8	8	13.5	30.0	S5 (40%)	F Class	IP-40
VL <b>2700</b> 10S	1360	2/1	1.75	≤80	Ø320	8	8	16.0	32.0	S5 (40%)	F Class	IP-40



## GEARLESS VL 3000 10S

Max Static Load	5500 Kg.
Voltage	400 V
Roping	2/1
Brake	110 V DC
Weight	480 Kg. (Approx)

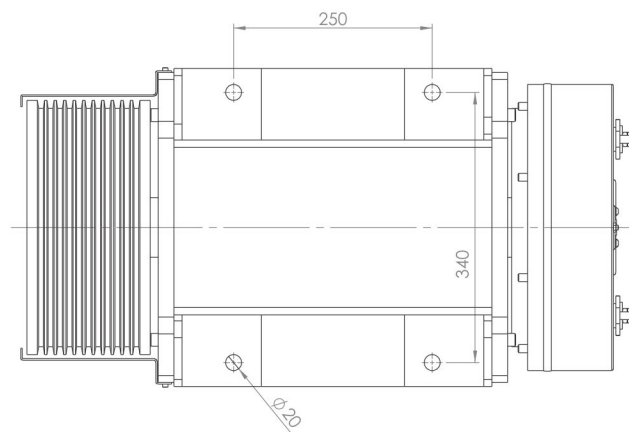
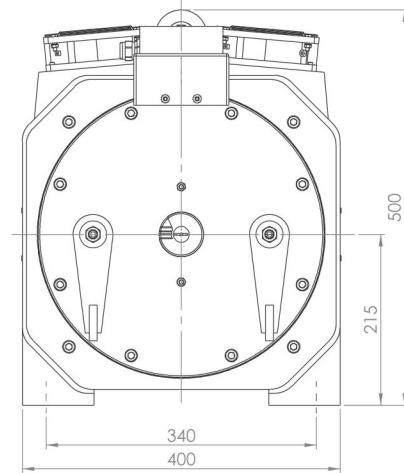
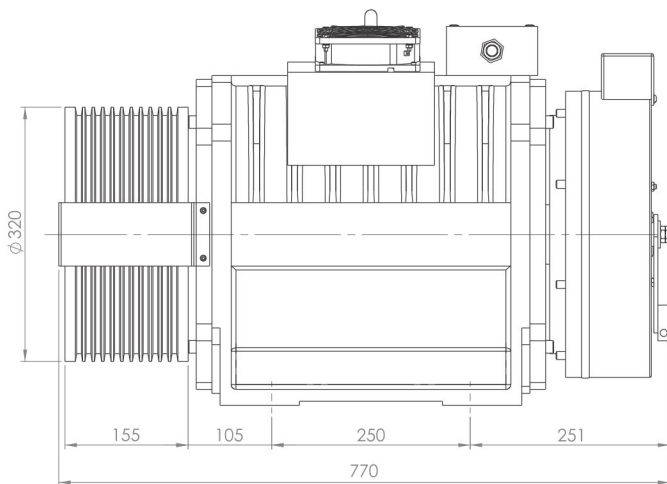

all dimensions are in mm.

Model	Load (in kg)	Roping	Speed (in m/sec)	Height (m)	Sheave (mm)	Rope (mm)	No. of Groove	Power (kW)	Amp	Rating	INS Class	IP Class
VL 3000 10S	1500	2/1	1.0	≤80	Ø400	10	8	10.4	38.0	S5 (40%)	F Class	IP-40
VI 3000 10S	1500	2/1	1.5	≤80	Ø400	10	8	15.3	40.5	S5 (40%)	F Class	IP-40
VL 3000 10S	1500	2/1	1.75	≤80	Ø400	10	8	18.5	43.5	S5 (40%)	F Class	IP-40



GEARLESS  
**VL 3200 10S**



Max Static Load	5500 Kg.
Voltage	400 V
Roping	2/1
Brake	110 V DC
Weight	470 Kg. (Approx)

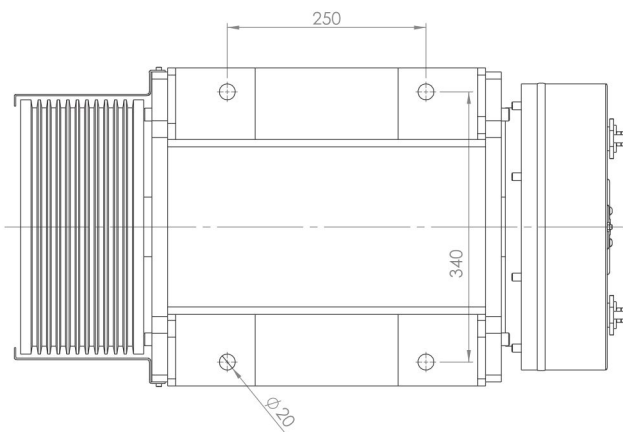
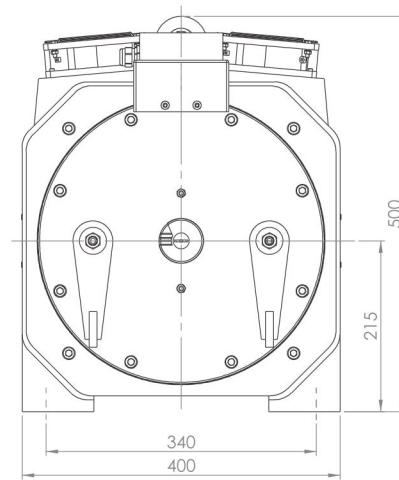
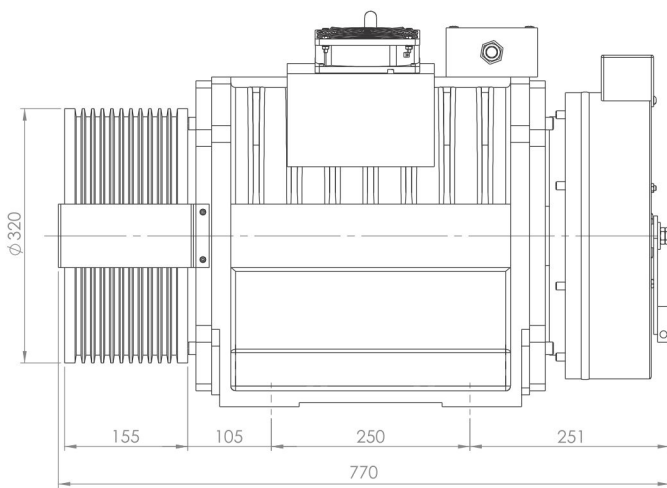
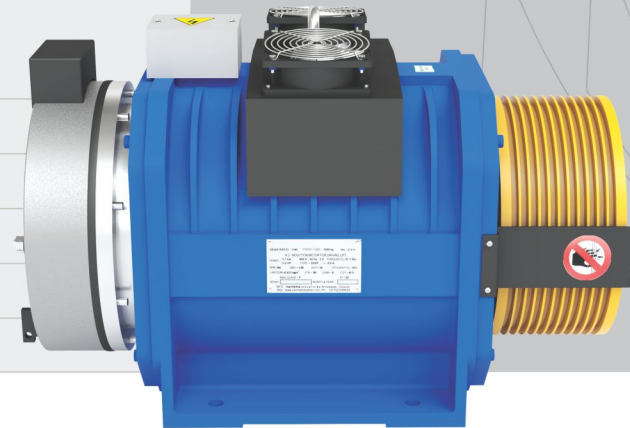

all dimensions are in mm.

Model	Load (in kg)	Roping	Speed (in m/sec)	Height (m)	Sheave (mm)	Rope (mm)	No. of Groove	Power (kW)	Amp	Rating	INS Class	IP Class
VL 3200 10S	1768	2/1	1.0	≤80	Ø320	8	10	12.0	32.5	S5 (40%)	F Class	IP-40
VL 3200 10S	1768	2/1	1.5	≤80	Ø320	8	10	18.0	36.5	S5 (40%)	F Class	IP-40
VL 3200 10S	1768	2/1	1.75	≤80	Ø320	8	10	21.0	45.5	S5 (40%)	F Class	IP-40



## GEARLESS VL 3500 10S

Max Static Load	5500 Kg.
Voltage	400 V
Roping	2/1
Brake	110 V DC
Weight	475 Kg. (Approx)

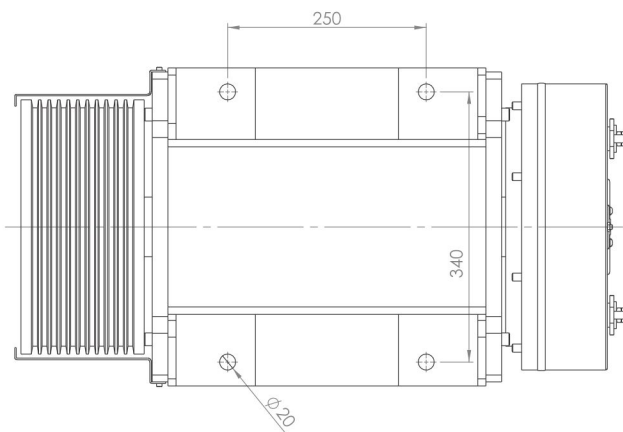
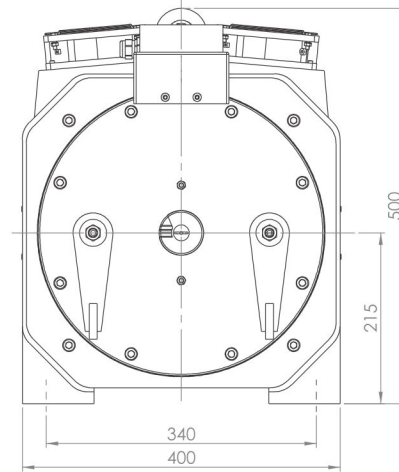
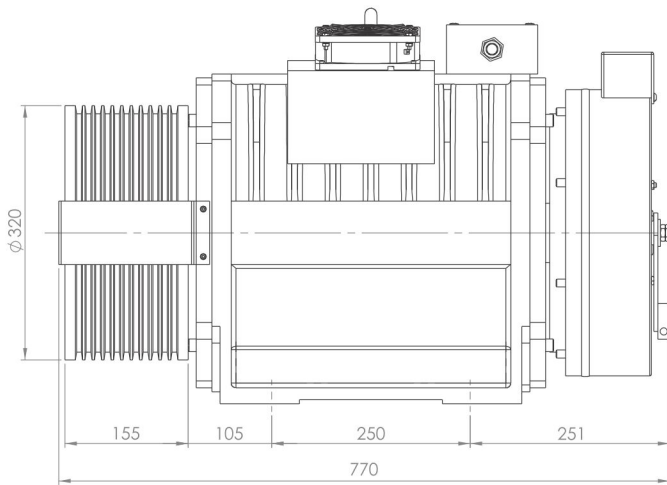
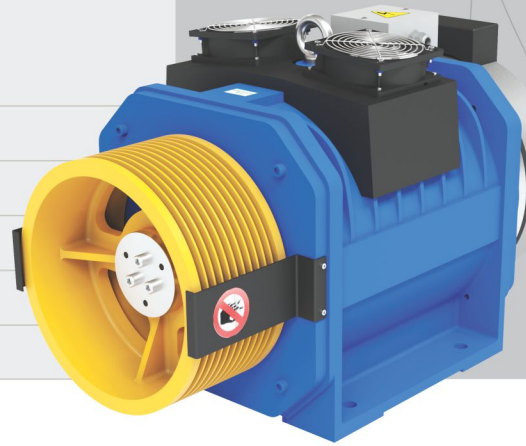

all dimensions are in mm.

Model	Load (in kg)	Roping	Speed (in m/sec)	Height (m)	Sheave (mm)	Rope (mm)	No. of Groove	Power (kW)	Amp	Rating	INS Class	IP Class
VL 3500 10S	2000	2/1	1.0	≤80	Ø320	8	10	13.6	38.5	S5 (40%)	F Class	IP-40
VI 3500 10S	2000	2/1	1.5	≤80	Ø320	8	10	20.5	43.5	S5 (40%)	F Class	IP-40
VL 3500 10S	2000	2/1	1.75	≤80	Ø320	8	10	24.0	52.5	S5 (40%)	F Class	IP-40



GEARLESS  
**VL 3700 10S**



Max Static Load	6500 Kg.
Voltage	400 V
Roping	2/1
Brake	110 V DC
Weight	530 Kg. (Approx)

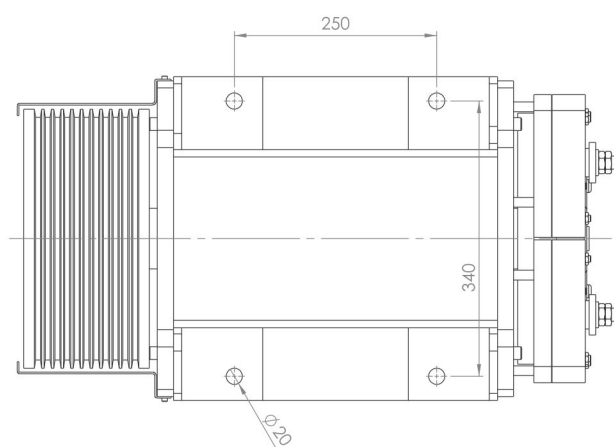
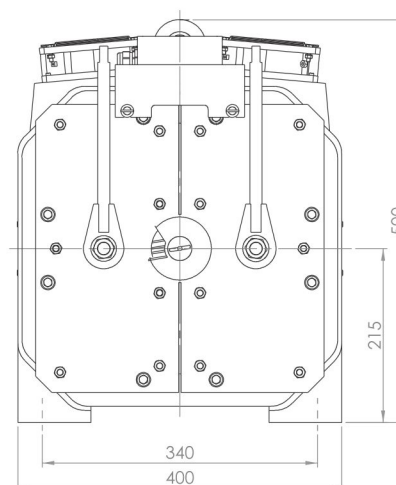
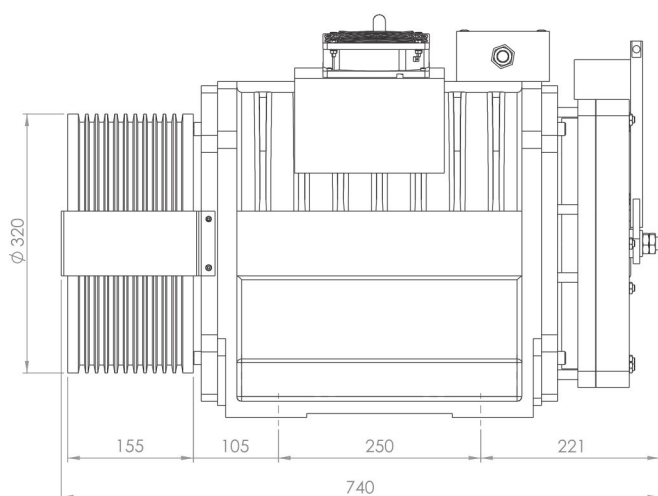
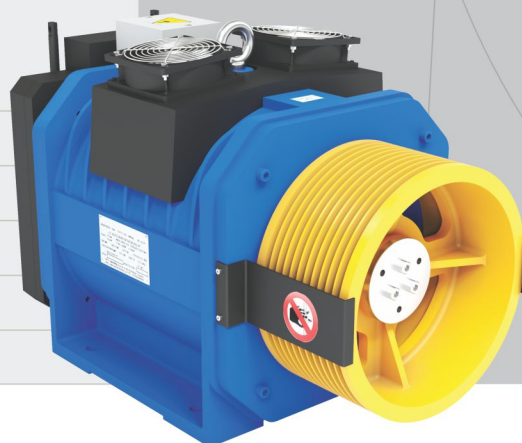

all dimensions are in mm.

Model	Load (in kg)	Roping	Speed (in m/sec)	Height (m)	Sheave (mm)	Rope (mm)	No. of Groove	Power (kW)	Amp	Rating	INS Class	IP Class
VL 3700 10S	2500	2/1	1.0	≤80	Ø320	8	11	16.8	42.5	S5 (40%)	F Class	IP-40
VL 3700 10S	2500	2/1	1.75	≤80	Ø320	8	11	25.5	52.5	S5 (40%)	F Class	IP-40



GEARLESS  
**VL 4000**10S



Max Static Load	6800 Kg.
Voltage	400 V
Roping	2/1
Brake	110 V DC
Weight	540 Kg. (Approx)

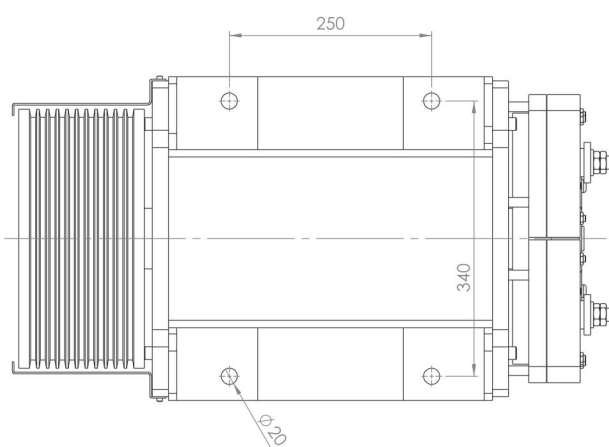
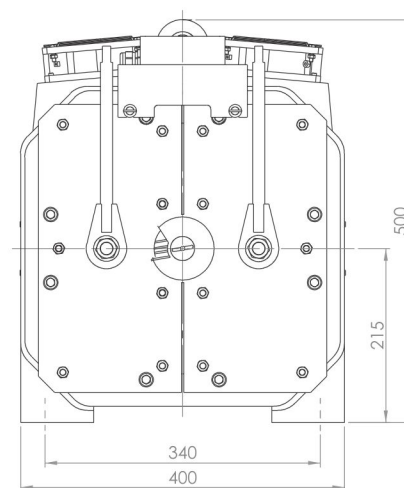
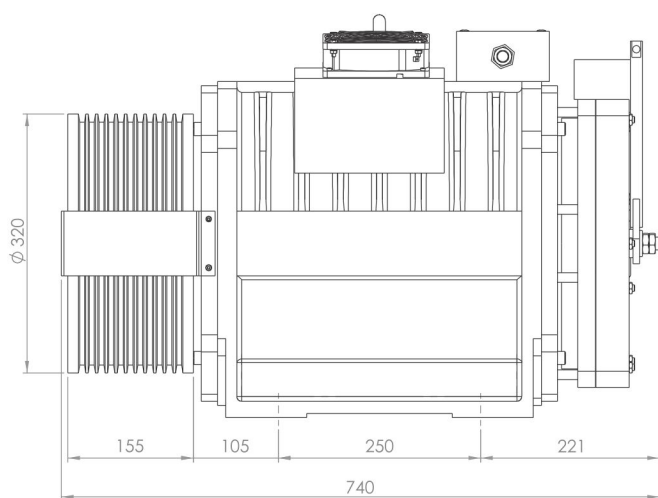
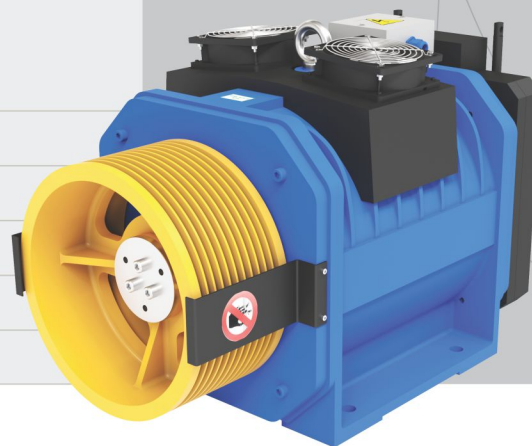

all dimensions are in mm.

Model	Load (in kg)	Roping	Speed (in m/sec)	Height (m)	Sheave (mm)	Rope (mm)	No. of Groove	Power (kW)	Amp	Rating	INS Class	IP Class
VL 4000 10S	2000	2/1	1.0	≤80	Ø400	10	8	1.3.6	47.5	S5 (40%)	F Class	IP-40
VL 4000 10S	3000	2/1	1.0	≤80	Ø320	8	11	16.9	51.5	S5 (40%)	F Class	IP-40

Export Region

Non VVVF Series



GEARED  
**VI 7.5 UT SUPER AC2**

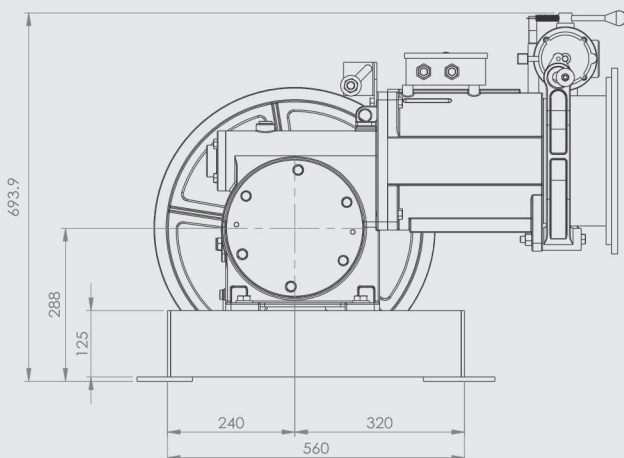
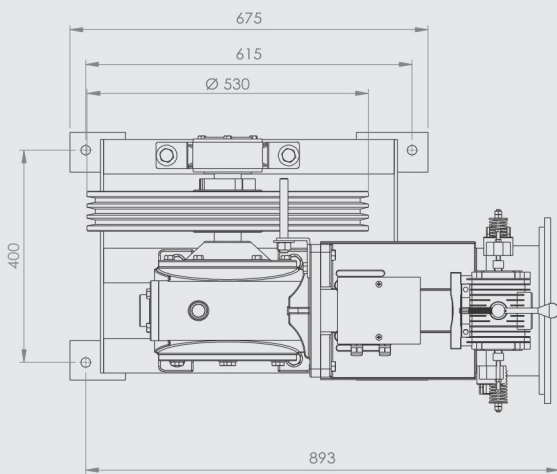

Max Static Load	3000 Kg.
Power Range (AC2)	5.5, kW. 4/16 Pole 50Hz 5.5, kW. 4/16 Pole 60Hz
Brake Voltage	48, 60, 110, 220 DC.
Sheave Range	510, 530, 560 mm.
Oil Capacity	3.5 Ltr. (Approx)
Weight	280 Kg. (Approx)

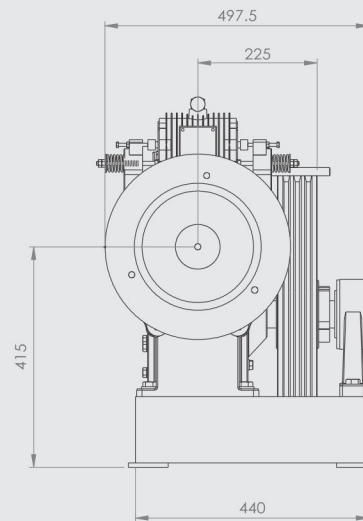

Model	Load (in kg)	Speed (in m/sec)	Ratio	Sheave	Rope	Ropeing	Power (kW)	Power (HP)	Travel
VI 7.5 UT SUPER AC2	544	1.00	1/40, 1/52	530	10/13 x 4/3	1:1	5.5	7.5	30
VI 7.5 UT SUPER AC2	1050	0.5	1/40, 1/52	530	10/13 x 4/3	2:1	5.5	7.5	30



GEARED  
VI10UT

SUPER AC2

Max Static Load	3600 Kg.
Power Range (AC2)	7.5, kW. 4/16 Pole 50Hz 7.5, kW. 4/16 Pole 60Hz
Brake Voltage	48, 60, 110, 220 DC.
Sheave Range	510, 530, 560, mm.
Oil Capacity	3.5 Ltr. (Approx)
Weight	320 Kg. (Approx)

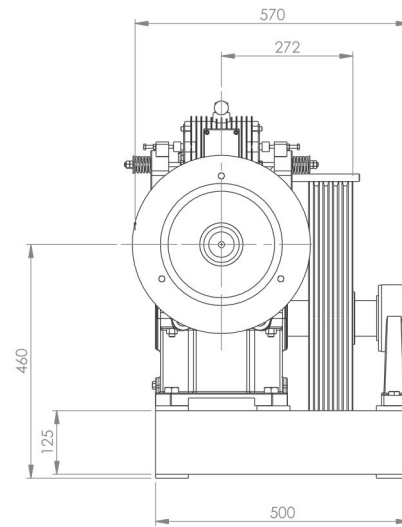
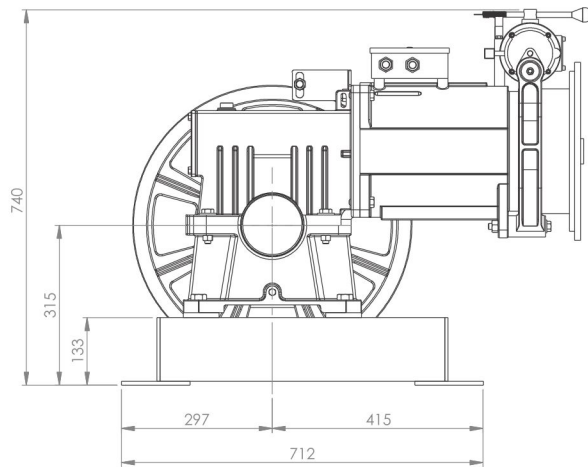
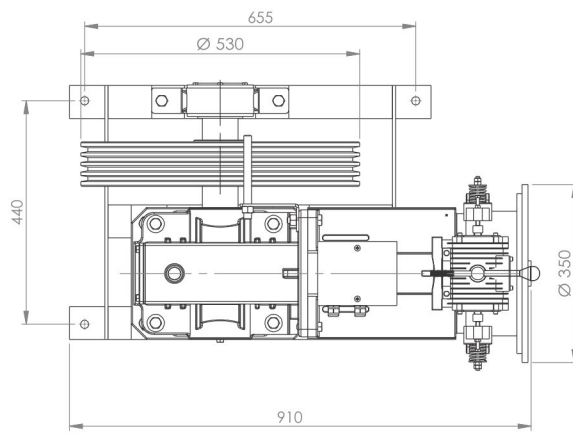
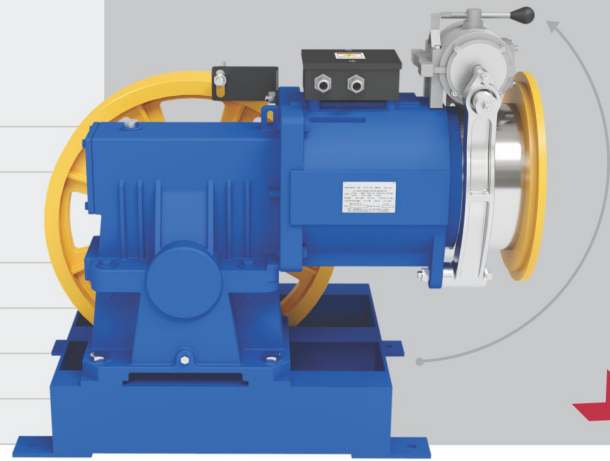

Model	Load (in kg)	Speed (in m/sec)	Ratio	Sheave	Rope	Ropeing	Power (kW)	Power (HP)	Travel
VI 10 UT SUPER AC2	680	1.00	1/43, 1/45	530	10/13 x 4/5	1:1	7.5	10	40
VI 10 UT SUPER AC2	1360	0.5	1/43, 1/45	530	10/13 x 4/5	2:1	7.5	10	40
<p>GEARED VI12.5UT   SUPER AC2</p>									
VI 12.5 UT SUPER AC2	884	1.00	1/43, 1/45	530	10/13 x 5/6	1:1	9.0	12.5	40
VI 12.5 UT SUPER AC2	1768	0.5	1/43, 1/45	530	10/13 x 5/6	2:1	9.0	12.5	40



## Safety Devices

### Over Speed Governor

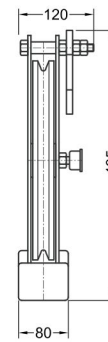
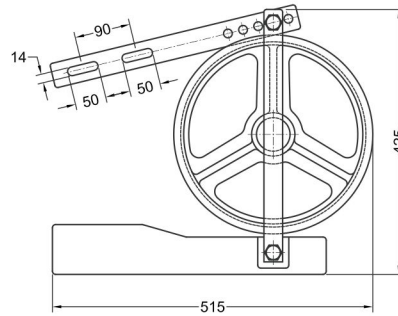
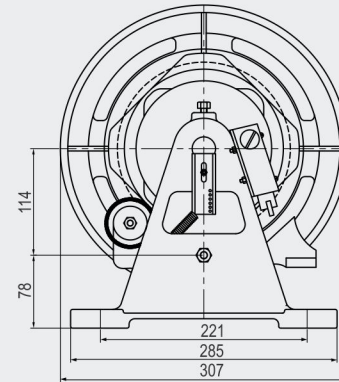
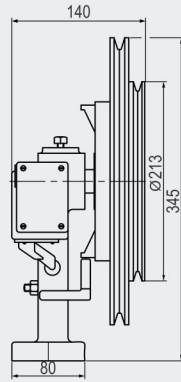

NOTE :- ALL DIMENSIONS ARE IN MM

### Diverter Sheave Bearing



Sheave Dia [ mm ]	Grove & Rope [ mm ]	Grove & Rope [ mm ]	Grove & Rope [ mm ]	Grove & Rope [ mm ]	Grove & Rope [ mm ]	Grove & Rope [ mm ]
205	3 x 8	4 x 8				
240		4 x 8	5 x 8			
305	3 x 13	4 x 13	5 x 13	6 x 13		
320		4 x 8	5 x 8	6 x 8	7 x 8	8 x 8, 10 x 8, 12 x 8
410	3 x 13	4 x 13	5 x 13	6 x 13	7 x 13	9 x 13
460	3 x 13	4 x 13	5 x 13	6 x 13		
510	3 x 13	4 x 13	5 x 13	6 x 13	7 x 13	
560	3 x 13	4 x 13	5 x 13	6 x 13	7 x 13	8 x 13
710		4 x 13	5 x 13	6 x 13	7 x 13	



# Roping Graph

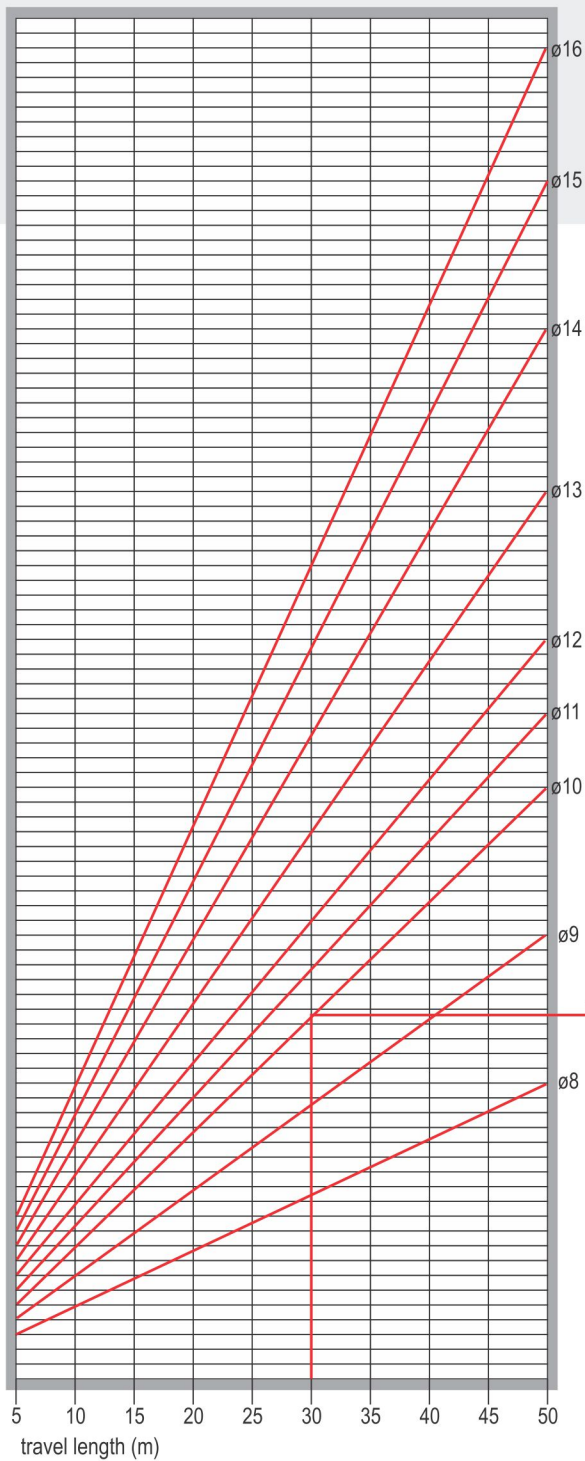

45	90	135	180	225	270	315	360	405	450
40	80	120	160	200	240	280	320	360	400
35	70	105	140	175	210	245	280	315	350
30	60	90	120	150	180	210	240	270	300
25	50	75	100	125	150	175	200	225	250
20	40	60	80	100	120	140	160	180	200
15	30	45	60	75	90	105	120	135	150
10	20	30	40	50	60	70	80	90	100
5	10	15	20	25	30	35	40	45	50
2.5	5	7.5	10	12.5	15	17.5	20	22.5	25

example

- weight of the ropes (kg)

subject to change without notice!



## Types of Lifts

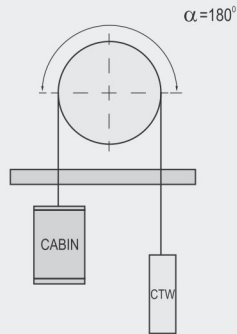

ABOVE Roping 1:1

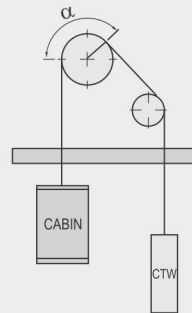

ABOVE Roping 1:1

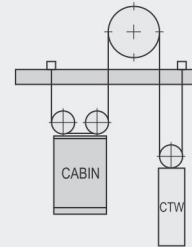

ABOVE Roping 2:1

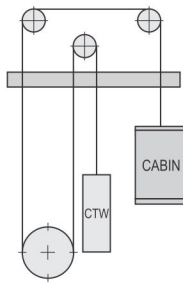

DOWN Roping 1:1

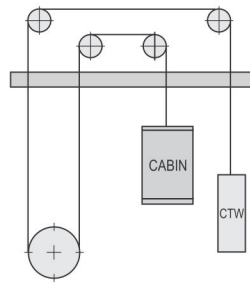

DOWN Roping 1:1

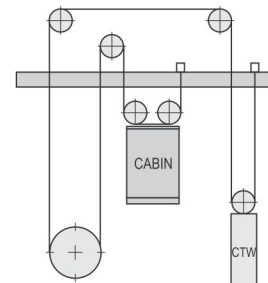

DOWN Roping 2:1

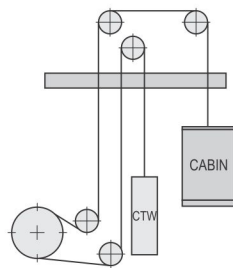

ON SIDE Roping 1:1

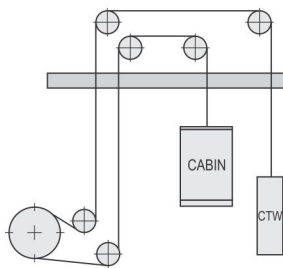

ON SIDE Roping 1:1

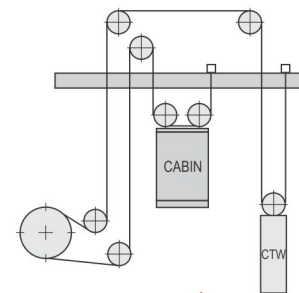

ON SIDE Roping 2:1

subject to change without notice!

## Types of Grooves

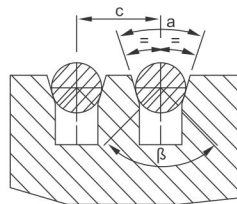

"V" Groove with Undercut  
 $a$  = Groove Angle  
 $B$  = Undercut Angle

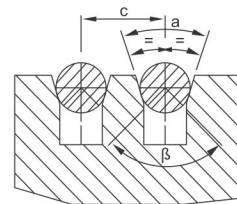

"U" Groove with Undercut  
 $a = 30^\circ$   
 $b = 105^\circ$

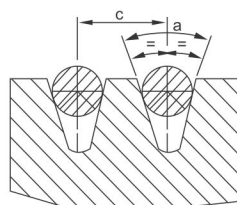

"V" Groove Type - A  
 $a = 30^\circ$

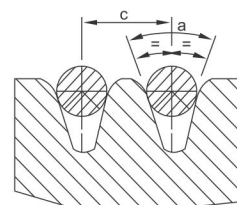

"V" Groove Type - B  
 $a = 30^\circ$



## Lubrication

### Mineral Oil Table

Brand							
Type	Alpha	EP	Spartan	Omala	Mobigear	Blasia	Energyn
	Sp220	Lubricant	EP 220	Oil 220	630	220	Gr - xp
		HD 220					220
Viscosity	16.5 (.e)	16.7 (.e)	15.1 (.e)	15.0 (.e)	15.8 (.e)	18 (.e)	16 (.e)
At 50c							

### Synthetic Oil Table

Brand							
Type	Tribol	EP	Ezl	Tivela	Gligoyle	Blasia	Energyn
	800/220	Lubricant	502	Wb	30	S 220	Sg - xp
		Sy 220					220
Viscosity	17 (.e)	17.2 (.e)	19 (.e)	20.0 (.e)	19.4 (.e)	20 (.e)	17 (.e)
At 50c							

#### Oil Change

For mineral after about 350 operation hours for synthetic oil after 700 operation hours.

For mineral oils every 12/18 months synthetic oils every 24/36 months depending on intensity of use.

#### Important

Do not mix synthetic oil with mineral oil.

#### Stating Up

Before running the machine which has been out of action for a long time it is important to make sure that the gear box is filled with the correct amount of oil more over one complete revolution of the sheave should be accomplished by hand after filling oil.

Use ISO-VG-320 grade of oil in gear change mineral oil every 12/18 months for synthetic oils 24/36 months depending on the intensity of use.



## Production Unit



We have Global Presence along with our Presence in  
**24 STATES OF INDIA**



- South Africa
- South America
- Algeria
- Lebanon
- Egypt
- Saudi Arabia
- Iraq
- Sri Lanka
- Bangladesh
- Vietnam



📍 449, Kathwada GIDC, Road No.11,  
Kathwada Road, Ahmedabad,  
Gujarat 382430.

📞 + 91 76230 44424, 88668 23957

✉ info@varshaindustries.com

🌐 www.varshaindustries.com