

www.sunriseenterprises.in.net

GEARED

Elevator
Traction
Machine

Technical Catalogues

LIDER

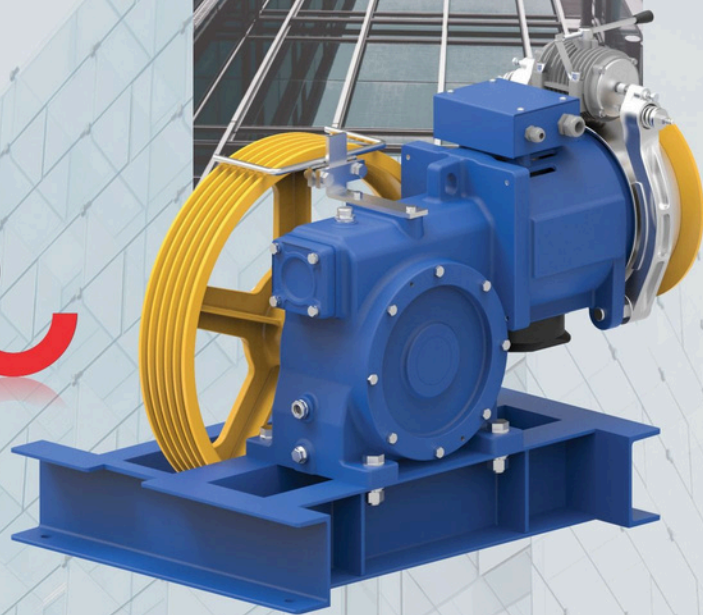

The **Quality** Inspires Trust



Sunrise Enterprises

GEARED TRACTION MACHINE

LIDER

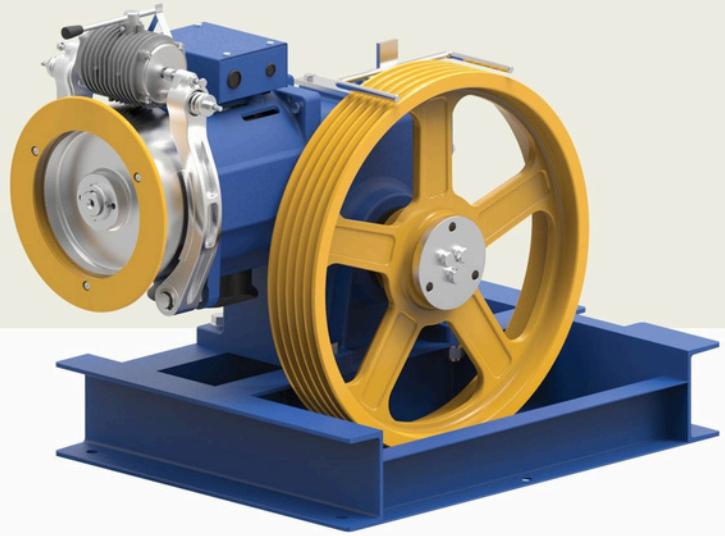

Static Load (kg)
3800



Gear Ratio
1/49, 1/59



Oil Capacity (Ltr)
4.0



Brake Voltage (DC)
110V, 220V



Weight of Machine (kg)
352*

* Weight of machine is varies according to selection of sheave, Motor.

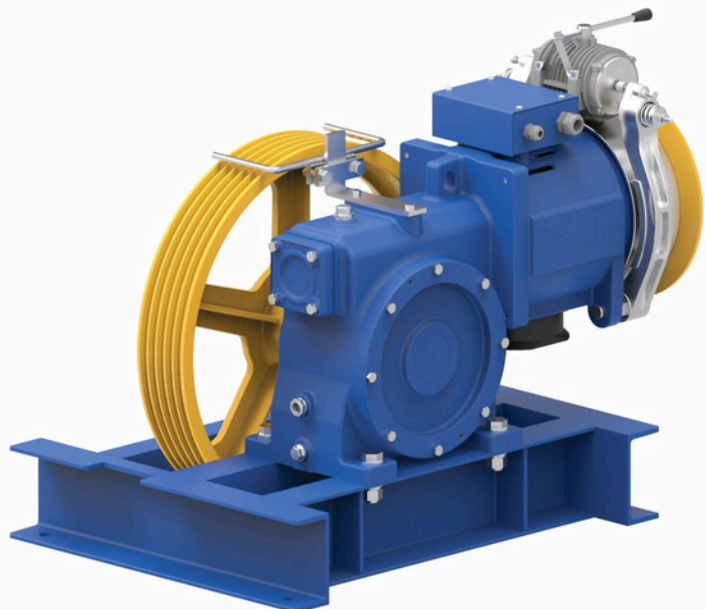

GEARED TRACTION MACHINE

LIDER

Listed loads don't include the rope's weight.
In order to know the net loads capacity, subtract rope's weight from the listed loads.

Position of the gearbox Up
Counter weight 50%
Plant efficiency 0.80

AC VVVF		400 V		50 Hz				Travelling : - 30 mtr		
Machine	Duty Load		Roping	Async. Speed	Ratio	Motor Detail		RPM	Rated Current	Sheave Specification
	Person	Kg		(m/sec)		(kw)	(HP)	(Async.)	(A)	Sheave Dia x Rope Dia. X No. of Groove
LIDER	13	884	1:1	0.70	1/59	7.5	10.0	1423	14.5	Ø 560 X 13mm X 4 Grv.
				1.00	1/49	9.0	12.5	1458	20.5	Ø 600 X 13mm X 4 Grv.
	1500	2:1	0.35	1/59	6.7	9.0	1445	13.5	Ø 560 X 13mm X 4 Grv.	
			0.50	1/49	7.5	10.0	1423	14.5	Ø 600 X 13mm X 4 Grv.	

Kindly contact us for various speed and load combination

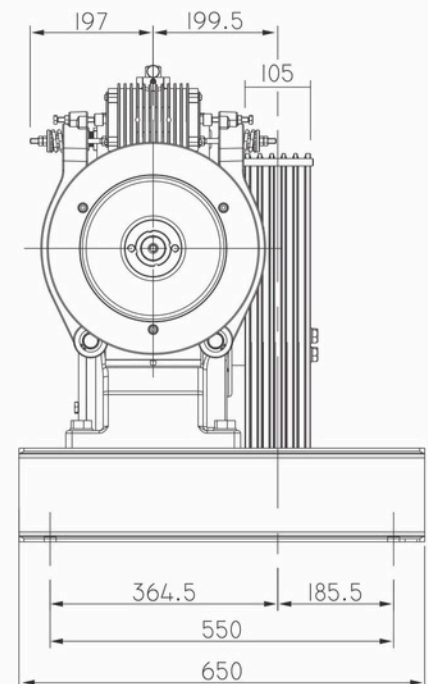
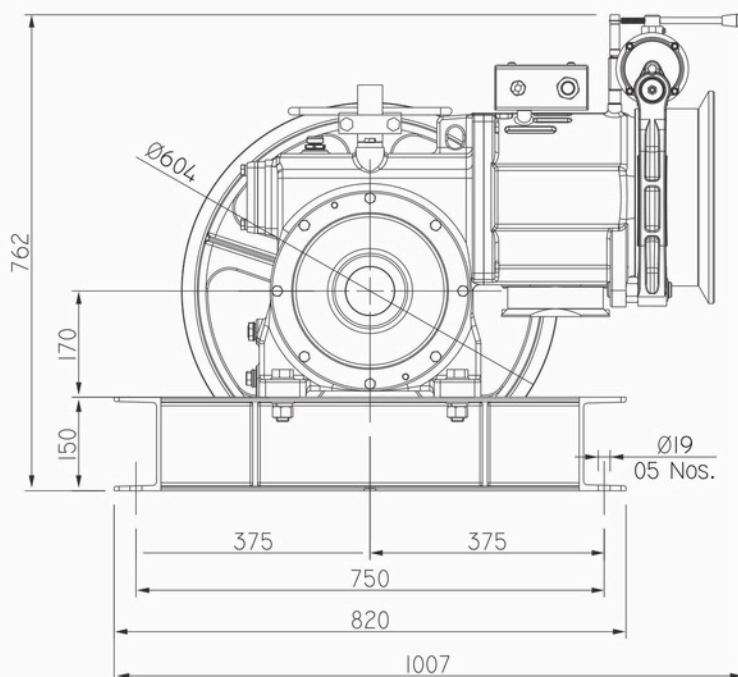

(All dimensions are in mm)